

LUHIX[®]



LUHIX

Rise Beyond The Ordinary

Luhix Mechanical Equipment Co., Ltd.



Shi Chuang Electronic Business
Park, Ningbo, Zhejiang, China.



+86 (0574) 2628 4842, +(86) 158 2557 7846



info@luhixlift.com, sales@luhixlift.com



www.luhixlift.com, www.luhix.com



LUHIX[®]

ABOUT US

Luhix Mechanical Equipment Co., Ltd. Is located in the city of Ningbo. Ningbo is an important port city located 240 kilometers south of Shanghai. Since it's established, the product technology of the company has always been leading in the industry worldwide.

Over the years, researchers of the company have been upgrading products and putting forward new design concepts. It has evolved to modern full-automatic production lines from semi-automatic and semi-manual production at the beginning, without man-made secondary pollution. Each product is practical and affordable with exquisite appearance; the excellent design of Human Mechanics makes the product comfortable to feel.

The company relies on first-class management and the technical team passing through the international quality system authenticating. We believe that improving the quality and lowering the cost is essential.

LUHIX continuously improve each new and old-fashioned product for excellence in order to ensure the quality of every product can make customers satisfied.



DIRECTORY

■ Shackle-----	04-07
■ Turnbuckle-----	08-11
■ Wire Rope Clip-----	12-15
■ Thimble-----	16-17
■ Bolt&Nut-----	18-19
■ Load Binder-----	20-21
■ Hook-----	22-23
■ Chain-----	24-25
■ Link&Ring-----	26-29
■ G80 Products-----	30-33

U.S.Screw Pin Anchor Shackles

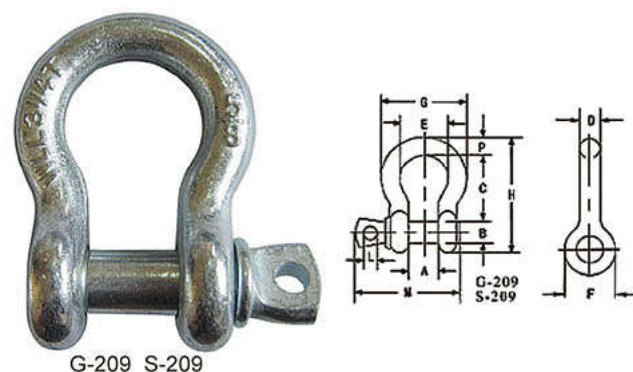

Screw Pin Anchor Shackles Meet the Requirements of Federal Specification RR-C-271D Type IVA, Grade A, Class2.

U.S.Screw Pin Chain Shackles

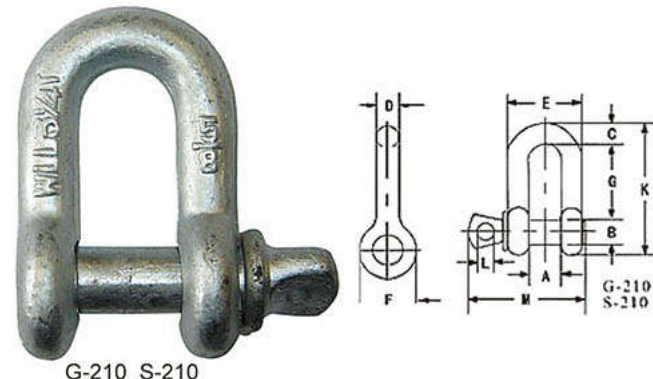

Screw Pin Chain Shackles Meet the Requirements of Federal Specification RR-C-271D Type IVB, Grade A, Class2.

European Trawling Shackle With Square Head Screw Pin

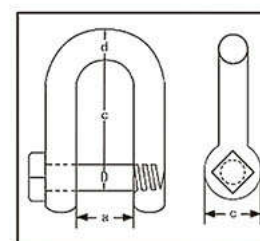

Product Code	SWL Ton	D (mm)	d (mm)	a (mm)	c (mm)	e (mm)	Weight (kg)
HK10A01	0.2	8	8	16	32	18	7
HK10A02	0.3	10	10	20	38	20	13.4
HK10A03	0.5	12	12	25	51	26	25
HK10A04	0.8	16	16	32	63	33	53
HK10A05	1.1	20	20	38	76	40	92
HK10A06	1.5	22	22	45	88	50	140
HK10A07	2	25	25	51	102	57	215
HK10A08	2.6	28	28	57	114	68	300
HK10A09	3.8	32	32	63	127	73	455
HK10A10	4.5	38	38	76	152	85	760

重型卸扣 (Heavy-duty shackle)

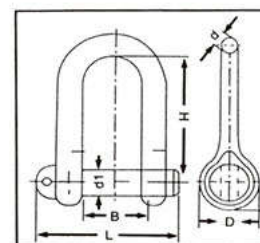

产品货号	卸扣号码	许用负荷 (千克)	适用钢丝绳最大直径 (毫米)	主要尺寸 (毫米)				
				横销螺纹直径 d1	卸扣本体直径 d	横销全长 L	环孔间距 B	环孔高度 H
HK12A01	0.2	200	4.7	M8	6	35	12	35
HK12A02	0.3	300	6.5	M10	8	44	16	45
HK12A03	0.5	500	8.5	M12	10	55	20	50
HK12A04	0.9	930	9.5	M16	12	65	65	60
HK12A05	1.4	1450	13	M20	16	86	32	80
HK12A06	2.1	2100	15	M24	20	101	36	90
HK12A07	2.7	2700	17.5	M27	22	111	40	100
HK12A08	3.3	3300	19.5	M30	24	123	45	110
HK12A09	4.1	4400	22	M33	27	137	50	120
HK12A010	4.9	4900	26	M36	30	153	58	130
HK12A011	6.8	6800	28	M42	36	176	64	150
HK12A012	9.0	9800	31	M48	42	197	70	170
HK12A013	10.7	10700	34	M52	45	218	80	190
HK12A014	16.0	16000	43.5	M64	52	262	100	235
HK12A015	21.0	24000	43.5	M76	65	321	99	256

Note: Drop forged, quenched and tempered, with alloy pins.
Max proof load is 2 times the working load limit. Min breaking strength is 6 times the working load limit.

U.S.Bolt Type Anchor & Chain Shackles



G-2130 S-2130

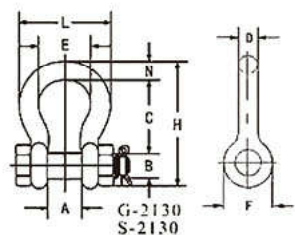

Bolt Type Anchor Shackles With Thin Head Bolt-nut
With Cotter Pin.Meets The Requirements of Federal
Specification RR-C-271D Type IVA,Grade A,Class3.



G-2150 S-2150

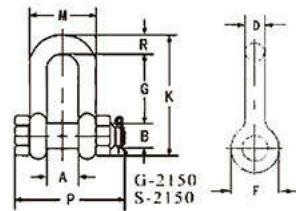

Bolt Type Chain Shackles With Thin Head Bolt-nut
Cotter Pin.Meets The Requirements of Federal
Specification RR-C-271D Type IVB,Grade A,Class3.

Product Code		Weight Each(kg)		Nominal Size (in.)	Working Load Limit(t)	Dimensions (mm)										
2130	2150	2130	2150			A	B	C	D	E	F	G	H	L	M	P
HK05A01	HK06A01	0.03	0.03	3/16	1/3	9.65	6.35	22.4	4.85	15.2	14.2	-	37.3	24.9	-	32.77
HK05A02	HK06A02	0.05	0.06	1/4	1/2	11.90	7.85	28.7	6.35	19.8	15.5	19.05	46.7	32.5	15.49	39.62
HK05A03	HK06A03	0.10	0.10	5/16	3/4	13.50	9.65	31.0	7.85	21.3	19.1	25.40	53.0	37.3	19.05	46.23
HK05A04	HK06A04	0.15	0.15	3/8	1	16.80	11.20	36.6	9.65	26.2	23.1	30.99	63.0	45.2	23.11	55.12
HK05A05	HK06A05	0.22	0.22	7/16	1-1/2	19.10	12.70	42.9	11.20	29.5	26.9	36.09	74.0	51.5	41.15	63.75
HK05A06	HK06A06	0.36	0.34	1/2	2	20.60	16.00	47.8	12.70	33.3	30.2	41.04	83.5	58.5	45.97	71.12
HK05A07	HK06A07	0.76	0.67	5/8	3-1/4	26.90	19.10	60.5	16.00	42.9	38.1	50.80	106.0	74.5	58.67	89.66
HK05A08	HK06A08	1.23	1.14	3/4	4-3/4	31.80	22.40	71.5	19.10	51.0	46.0	60.45	126.0	89.0	69.85	103.38
HK05A09	HK06A09	1.79	1.74	7/8	6-1/2	36.60	25.40	84.0	22.40	58.0	53.0	71.37	148.0	102.0	81.03	119.63
HK05A10	HK06A10	2.57	2.52	1	8-1/2	42.90	28.70	95.5	25.40	68.5	60.5	81.03	167.0	119.0	93.73	134.87
HK05A01	HK06A11	3.75	3.45	1-1/8	9-1/2	46.00	31.80	108.0	28.70	74.0	68.5	90.93	190.0	131.0	103.12	149.86
HK05A12	HK06A12	5.31	4.90	1-1/4	12	51.50	35.10	119.0	31.80	82.5	76.0	100.08	210.0	146.0	115.06	165.35
HK05A13	HK06A13	7.18	6.24	1-3/8	13-1/2	57.00	38.10	133.0	35.10	92.0	84.0	111.25	233.0	162.0	127.00	183.13
HK05A14	HK06A14	9.43	8.39	1-1/2	17	60.50	41.40	146.0	38.10	98.5	92.0	122.17	254.0	175.0	136.05	196.34
HK05A15	HK06A15	15.40	14.20	1-3/4	25	73.00	51.00	178.0	44.50	127.0	106.0	146.05	313.0	225.0	162.05	229.87
HK05A16	HK06A16	23.70	21.20	2	35	82.50	57.00	197.0	51.00	146.0	122.0	171.45	348.0	253.0	184.15	264.41
HK05A17	HK06A17	44.60	38.60	2-1/2	55	105.00	70.00	267.0	66.50	184.0	145.0	203.20	453.0	327.0	238.25	344.42
HK05A18	HK06A18	70.00	56.00	3	85	127.00	82.50	330.0	76.00	200.0	165.0	215.90	546.0	365.0	279.40	419.10
HK05A19	HK06A19	120.00	-	3-1/2	120	133.00	95.50	372.0	92.00	229.0	203.0	-	626.0	419.0	-	482.60
HK05A20	HK06A20	153.00	-	4	150	140.00	108.00	368.0	104.00	254.0	229.0	-	653.0	468.0	-	501.65

Note:Drop forged,quenched and tempered,with alloy pins.

Max proof load is 2 times the working load limit.Min breaking strength is 6 times the working load limit.

JIS Shackles Commercial Type

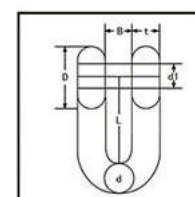

Product Code	Nominal Size (mm)	B	D	L	d1	SWL (T)	(2)
HK15A01	4.8	10	10	18.5	5.0	0.09	0.014
HK15A02	6.0	12	11	25.0	6.5	0.15	0.028
HK15A03	8.0	14	15	31.0	8.5	0.25	0.049
HK15A04	9.0	18	17	36.0	10.0	0.40	0.049
HK15A05	12.0	24	23	46.0	13.0	0.60	0.180
HK15A06	16.0	30	32	59.0	17.0	0.80	0.420
HK15A07	19.0	36	37	74.0	20.0	1.00	0.720
HK15A08	22.0	43	43	86.0	23.0	1.50	1.180
HK15A09	25.0	47	50	95.0	27.0	2.00	1.800
HK15A10	28.0	55	56	110.	30.0	2.50	2.500
HK15A11	32.0	64	64	130.	34.0	3.20	3.700
HK15A12	38.0	76	76	145	40.0	4.20	6.100
HK15A13	44.0	80	90	160	47.0	6.50	-
HK15A14	50.0	100	100	185	53.0	8.00	-
HK15A15	65.0	110	130	240	68.0	15.00	-
HK15A16	75.0	120	150	300	78.0	20.00	-

European D Shackle With Screw Pin

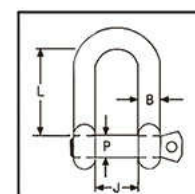

Product Code	Pin P(mm)	Body B(mm)	Jaw J(mm)	Inside L(mm)	Breaking Load*	Weight Each(g)
HK08A01	4.0	4.0	8.0	16	800Kgs	7
HK08A02	5.0	5.0	10.0	20	1500Kgs	13
HK08A03	6.0	6.0	13.0	25	1950Kgs	24
HK08A04	8.0	8.0	16.0	32	3000Kgs	53
HK08A05	9.5	9.5	19.0	38	4800Kgs	97
HK08A06	11.0	11.0	22.0	44	6000Kgs	152
HK08A07	12.7	12.7	26.0	52	7500Kgs	237
HK08A08	16.0	14.3	29.0	58	10000Kgs	450
HK08A09	19.0	16.0	32.0	64	14000Kgs	585

European Bow Shackle With Screw Pin

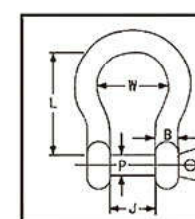

Product Code	Pin P(mm)	Body B(mm)	Jaw J(mm)	Inside L(mm)	Breaking Load*	Weight Each(g)
HK09A01	4.0	4.0	8.0	16	800	7
HK09A02	5.0	5.0	10.0	20	1500	13
HK09A03	6.0	6.0	13.0	25	1950	24
HK09A04	8.0	8.0	16.0	32	3000	53
HK09A05	9.5	9.5	19.0	38	4800	97
HK09A06	11.0	11.0	22.0	44	6000	152
HK09A07	12.7	12.7	26.0	52	7500	237
HK09A08	16.0	14.3	29.0	58	10000	450
HK09A09	19.0	16.0	32.0	64	14000	585

U.S.Federal Specification Turnbuckles (FF-T791b)

Proof Load Is 2.5 Times The Working Load Limit. Ultimate Load Is 5 Times The Working Load Limit.



Product Code	Size(Diameter x Take-Up)	Average Overall Length with Ends in Closed Position	Approx. Weight Each(lbs)					Working Load Limit (LBS)	
			Eyes and/or Hooks	Jaw& Eye	Jaw& Jaw	Stub End	Bodies Only	Hook&Hook Hook&Eye	Eye&Eye Jaw&Eye Jaw&Jaw Stub End
HK01B01	1/4"x4"	8-1/4	.3	.3	.4	.29	.17	400	500
HK01B02	5/16"x4 1/2"	9-9/16	.5	.35	.58	.46	.25	700	800
HK01B03	3/8"x6"	11-7/8	.75	.82	.93	.75	.3	1000	1200
HK01B04	1/2"x6"	13-5/16	1.50	1.62	1.68	1.36	.55	1500	2200
HK01B05	1/2"x9"	16-5/16	1.75	1.82	1.85	1.69	.74	1500	2200
HK01B06	1/2"x12"	19-5/16	2.18	2.19	2.20	2.0	.93	1500	2200
HK01B07	5/8"x6"	15-1/2	2.63	2.59	2.82	2.15	.91	2250	3500
HK01B08	5/8"x9"	18-1/2	3.00	3.01	3.25	2.7	1.2	2250	3500
HK01B09	5/8"x12"	21-1/2	3.25	3.50	3.75	3.22	1.5	2250	3500
HK01B10	3/4"x6"	17	3.75	4.25	4.68	3.25	1.3	3000	5200
HK01B11	3/4"x9"	20	4.50	5.00	5.38	4.0	1.7	3000	5200
HK01B12	3/4"x12"	23	5.75	5.75	6.12	4.65	2.12	3000	5200
HK01B13	3/4"x18"	29	7.00	7.25	7.25	6.12	2.93	3000	5200
HK01B14	7/8"x6"	18	-	-	-	4.75	2.0	4000	7200
HK01B15	7/8"x12"	24-5/8	8.38	8.88	9.36	6.67	3.0	4000	7200
HK01B16	7/8"x18"	30-5/8	10.25	10.60	11.44	8.75	4.12	4000	7200
HK01B17	1"x6"	20-5/8	-	-	-	6.41	2.5	5000	10000
HK01B18	1"x12"	26-5/8	11.25	12	12.88	8.9	3.86	5000	10000
HK01B19	1"x18"	32-5/8	14	14.75	16.1	11.7	5.5	5000	10000
HK01B20	1"x24"	38-5/8	17	17.75	18.6	14.3	7	5000	10000
HK01B21	1-1/4"x6"	20	-	-	-	10.4	4	6500	15200
HK01B22	1-1/4"x12"	29-7/8	19	21.2	23.6	14.2	5.93	6500	15200
HK01B23	1-1/4"x18"	35-7/8	24.1	26	26.6	18	8	6500	15200
HK01B24	1-1/4"x24"	41-7/8	25	28.7	31.2	21.8	10	6500	15200
HK01B25	1-1/2"x6"	22-1/2	-	-	-	15.4	5.8	7500	21400
HK01B26	1-1/2"x12"	32-3/8	27	31.1	35.5	20.5	8.4	7500	21400
HK01B27	1-1/2"x18"	38-3/8	31.2	36.4	40.7	26.2	11.5	7500	21400
HK01B28	1-1/2"x24"	44-3/8	38.2	44.2	47.6	31.4	14.1	7500	21400
HK01B29	1-3/4"x6"	-	-	-	-	22.7	8.75	12500	28000
HK01B30	1-3/4"x18"	41-3/4	45.0	48.8	52.4	-	-	12500	28000
HK01B31	1-3/4"x24"	47-3/4	58	60	64	43.9	19.5	12500	28000
HK01B32	2"x6"	-	-	-	-	31.5	12.5	16500	37000
HK01B33	2"x24"	51-3/4	90	102	115	60.3	27.5	16500	37000
HK01B34	2-1/2"x6"	-	-	-	-	60.8	27.0	27000	60000
HK01B35	2-1/2"x24"	58-1/2	183	180	200	110	54.0	27000	60000
HK01B36	2-3/4"x24"	61-1/2	180	214	248	-	54.0	34000	75000

Turnbuckles Frame Type (Forged Steel)

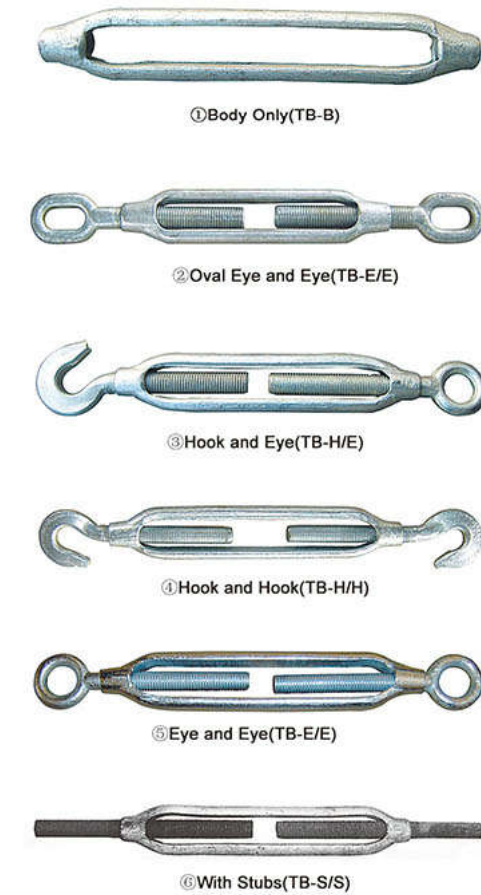
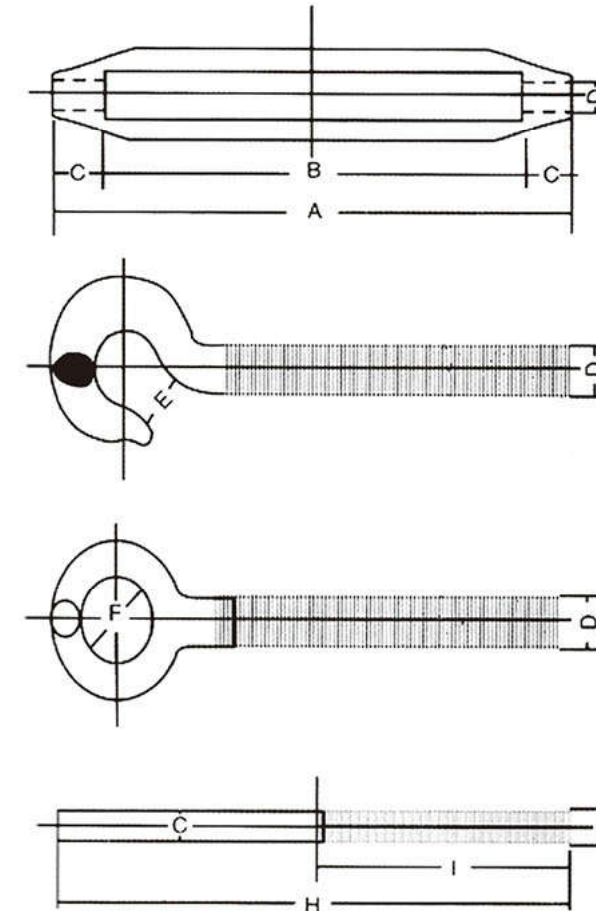

① ⑥ Size and Weights(Approx)

Product Code	Nominal Size (D)	① Body Only					② Eye and Eye			③ Hook and Eye			④ Hook and Hook		⑥ With Stubs			
		A	B	C	T.L	W/Pc	F	T.L	W/Pc	E	T.L	W/Pc	T.L	W/Pc	H	*	G	W/Pc
		mm	mm	mm	Ton	kg	mm	Ton	kg	mm	Ton	kg	Ton	kg	mm		mm	kg
HK02B01	6	100	45	11.0	1.0	0.08	10	0.1	0.116	9	0.04	0.112	0.04	0.114	80	50	5.3	0.112
HK02B02	8	125	100	12.5	1.2	0.15	12	0.2	0.22	9	0.08	0.215	0.08	0.218	100	63	6.9	0.220
HK02B03	9	150	120	12.5	1.5	0.17	16	0.5	0.295	11	0.15	0.290	0.15	0.293	130	75	8.3	0.273
HK02B04	12	200	164	18.0	2.0	0.29	20	2.0	0.600	16	0.35	0.570	0.35	0.585	150	100	11.2	0.510
HK02B05	16	250	202	21.5	3.0	0.52	22	3.0	1.070	19	0.70	1.030	0.70	1.050	180	125	14.2	0.950
HK02B06	19	300	250	25.0	4.0	0.85	28	4.0	1.790	20	1.00	1.770	1.00	1.780	220	150	17.2	1.620
HK02B07	22	325	269	28.0	5.0	1.17	33	5.0	2.550	21	1.50	2.60	1.50	2.580	250	165	20.3	2.340
HK02B08	25	350	285	32.5	6.0	1.69	35	6.0	3.800	26	2.00	3.73	2.00	3.770	270	175	23.3	3.270
HK02B09	32	400	310	45.0	8.0	3.51	36	10.0	7.600	34	3.00	7.44	3.00	7.520	300	200	29	6.520

Turnbuckles DIN1480

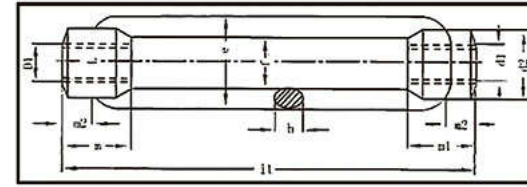

d1	M6	M8	M10	M12	M16	M20	M24	M26	M30	M36	M42	M48
Product Code	HK03 B01	HK03 B02	HK03 B03	HK03 B04	HK03 B05	HK03 B06	HK03 B07	HK03 B08	HK03 B09	HK03 B10	HK03 B11	HK03 B12
d2	12	15	18	21	27	34	39	45	55	63	80	80
e	19	23	30	34	42	52	60	74	86	104	135	135
f	9	11	14	16	20	24	28	34	40	50	65	65
h min	6	8	9	11	14	17	20	23	28	32	40	40
L1	110	110	125	125	170	200	255	255	295	330	355	355
m1	12	15	18	21	27	34	39	45	55	63	78	78
m2 max	6	8	9	11	14	17	20	23	28	32	39	39

Korean Type Turnbuckles (Malleable)

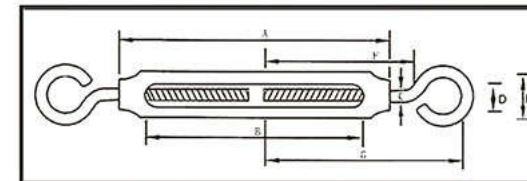

Product Code	Size inch	A	B	C	D	E	F	G	Weight Each g
HK04B01	5/16	90	70	8	11	22	65	95	145
HK04B02	3/8	160	130	9	17	30	85	130	345
HK04B03	1/2	190	155	10	20	30	95	150	560
HK04B04	1/2(L)	255	215	10	30	35	140	190	790
HK04B05	5/8	250	200	15	25	45	130	190	1120
HK04B06	5/8(L)	350	300	15	30	45	180	240	1540
HK04B07	3/4	250	200	20	35	45	140	210	1670
HK04B08	3/4(L)	300	245	20	40	55	170	240	2050
HK04B09	7/8	330	260	22	31	62	170	240	2565
HK04B10	1	350	280	25	36	66	180	250	3655

Turnbuckles Commercial Type (Malleable Iron)

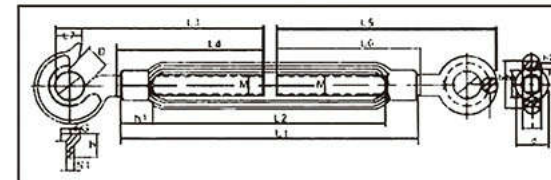

Product Code	SWL kg	A	B	C	D	E	F	G	L	Weight Each kg
HK05B01	100	6x100mm	145	215	12	10	6	6	100	0.16
HK05B02	200	8x125mm	185	280	14	12	8	8	125	0.24
HK05B03	300	10x150mm	210	325	16	14	9	9	150	0.39
HK05B04	500	12x200mm	275	430	19	18	11	11	200	0.64
HK05B05	1000	16x250mm	345	540	23	24	14	14	250	1.44
HK05B06	1500	20x300mm	435	670	28	26	18	18	300	2.45
HK05B07	2200	22x320mm	480	740	34	32	20	20	325	3.60
HK05B08	3000	24x350mm	555	830	36	36	21	21	350	5.00

Turnbuckles Rigging Screw

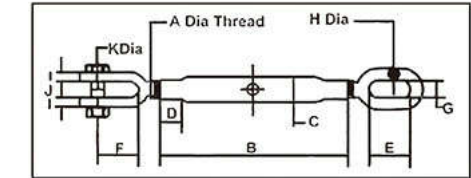

Product Code	SWL	A	B	C	D				E			Weight
	m.Tons	DIA SCREW	LENGTH OF BODY	DIA OF BODY	JAW				OVAL EYE			PER
					DIA(mm)		INSIDE(mm)		DIA (mm)	INSIDE (mm)		piece
					D1	D2	Length D3	Hidth D4	E1	Length E2	Hidth E3	kg
HK06B01	0.100	6	102	12	3	5	15	7	6	15	8	0.11
HK06B02	0.150	88	110	15	4	6	16	9	7	19	10	0.23
HK06B03	0.375	10	152	21	5	8	21	11	8	25	11	0.28
HK06B04	0.500	12	175	27	6	10	25	13	11	30	14	0.28
HK06B05	0.750	16	229	27	10	12	40	18	14	41	16	1.40
HK06B06	1.125	20	229	33	12	16	45	20	16	51	22	2.00
HK06B07	1.600	22	305	33	15	18	48	24	16	51	22	3.50
HK06B08	2.000	24	325	42	16	22	65	28	19	57	25	4.00
HK06B09	2.750	28	356	48	18	22	59	30	19	57	28	4.50
HK06B10	3.750	33	381	48	20	27	62	34	22	65	35	6.50
HK06B11	4.250	35	381	60	22	28	68	38	22	65	36	8.00
HK06B12	5.000	39	406	60	24	33	74	42	25	74	38	11.00

Hamburg Turnbuckle/DD Turnbuckle

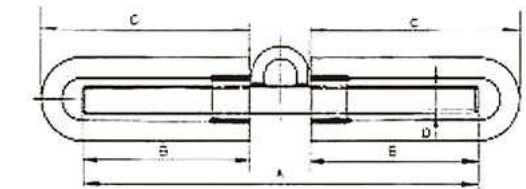

Product Code	SIZE DxA	B	C	Breaking Load	Weight
				Tons	kgs
HK07B01	20x450	200	230	9.5	2.30
HK07B02	20x500	220	250	9.5	2.50
HK07B03	24x400	170	210	13.5	3.50
HK07B04	24x500	220	250	13.5	4.00
HK07B05	27x400	170	210	18	4.40
HK07B06	27x500	220	250	18	5.00
HK07B07	28x400	170	215	19	4.50
HK07B08	30x400	170	220	21	5.00
HK07B09	30x500	220	350	21	5.50

Die Cast Turnbuckle



Product Code	Size (in)	APPROX WEIGHT/100PC (kg)
HK08B01	5/32x1-1/4	1.9
HK08B02	3/16x1-5/8	3.2
HK08B03	7/32x2	4.4
HK08B04	1/4x2-3/8	6.5
HK08B05	5/16x2-3/4	11.9
HK08B06	3/8x3	18.0

U.S. Type Drop Forged Wire Rope Clips

Meet The Requirements Of Federal Specification
FF-C-450 Type 1, Class 1.

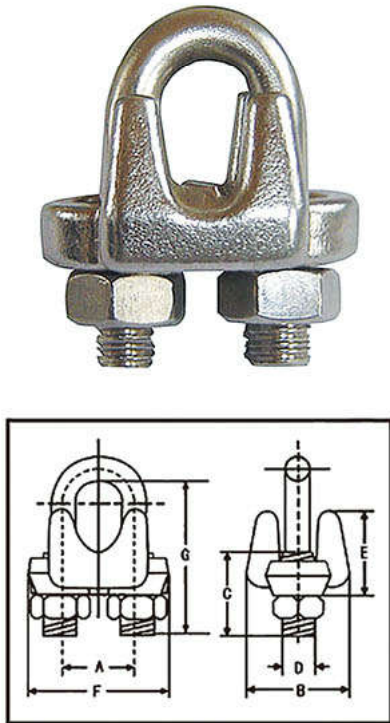

Product Code	Rope size (in)	Dimensions (in)					Weight Each (Kg/pc)
		A	G	F	D	E	
HK01C01	1/8	0.47	0.72	0.94	0.22	0.41	0.027
HK01C02	3/16	0.59	0.97	1.16	0.25	0.50	0.045
HK01C03	1/4	0.75	1.03	1.44	0.31	0.66	0.091
HK01C04	5/16	0.88	1.38	1.69	0.38	0.72	0.136
HK01C05	3/8	1.00	1.50	1.94	0.44	0.91	0.213
HK01C06	7/16	1.19	1.88	2.28	0.50	1.03	0.345
HK01C07	1/2	1.19	1.88	2.28	0.50	1.13	0.363
HK01C08	9/16	1.31	2.25	2.50	0.56	1.22	0.472
HK01C09	5/8	1.31	2.38	2.50	0.56	1.34	0.481
HK01C10	3/4	1.50	2.75	2.84	0.62	1.41	0.680
HK01C11	7/8	1.75	3.12	3.16	0.75	1.59	0.960
HK01C12	1	1.88	3.50	3.47	0.75	1.78	1.180
HK01C13	1 1/8	2.00	3.88	3.59	0.75	1.91	1.32
HK01C14	1 1/4	2.31	4.25	4.13	0.88	2.19	1.95
HK01C15	1 3/8	2.38	4.63	4.19	0.88	2.31	2.09
HK01C16	1 1/2	2.59	4.94	4.44	0.88	2.44	2.45
HK01C17	1 5/8	2.75	5.31	4.75	1.00	2.66	3.18
HK01C18	1 3/4	3.06	5.75	5.28	1.13	2.94	4.20
HK01C19	2	3.38	6.44	5.88	1.25	3.28	5.90
HK01C20	2 1/4	3.88	7.13	6.38	1.25	3.19	7.26
HK01C21	2 1/2	4.13	7.69	6.63	1.25	3.69	8.62

Din741 Galv Malleable Wire Rope Clips

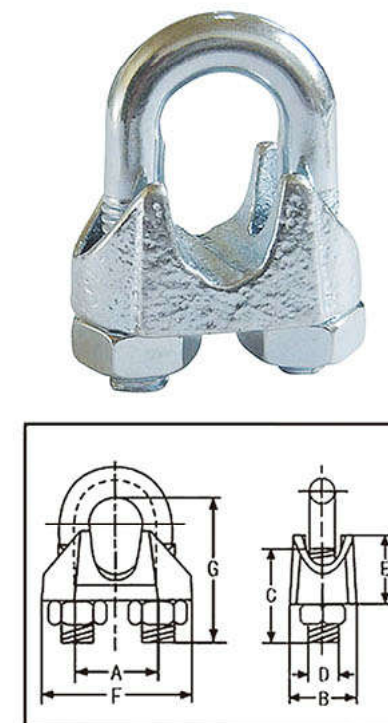

Product Code	Rope Size (mm)	Dimensions (mm)						Weight Each (Kg/pc)
		A	B	C	D	F	G	
HK03C01	3	9	10	12	4	21	20	0.014
HK03C02	5	11	11	13	5	23	24	0.015
HK03C03	6.5	13	12	15	5	26	28	0.021
HK03C04	8	16	14	19	6	30	34	0.041
HK03C05	10	19	18	22	8	34	42	0.068
HK03C06	11	20	19	22	8	36	54	0.072
HK03C07	13	24	23	30	10	42	55	0.130
HK03C08	14	25	23	30	10	44	57	0.135
HK03C09	16	29	26	33	12	50	63	0.210
HK03C10	19	32	29	38	12	54	75	0.280
HK03C11	22	37	33	44	14	61	85	0.400
HK03C12	26	41	35	45	14	65	95	0.440
HK03C13	30	48	37	50	16	74	110	0.660
HK03C14	34	52	42	55	16	80	120	0.850
HK03C15	40	58	45	60	16	88	140	1.040

U.S. Type Galv Malleable Wire Rope Clips

Meet The Requirements Of Federal Specification
FF-C-450 Type 1, Class 2.

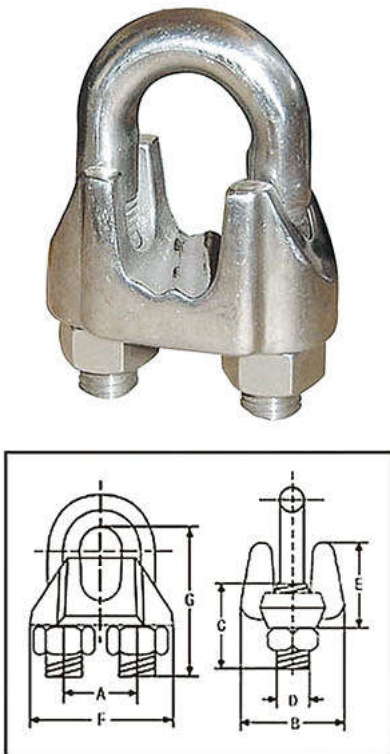

Product Code	Rope Size (in)	Dimensions (in)							Weight Each (Kg/pc)
		A	B	C	D	E	F	G	
HK02C01	1/16	0.38	0.45	0.45	0.15	0.45	0.69	0.65	0.0136
HK02C02	1/8	0.50	0.56	0.50	0.18	0.50	0.94	0.81	0.0182
HK02C03	3/16	0.56	0.63	0.56	0.25	0.56	1.06	0.94	0.0286
HK02C04	1/4	0.75	0.75	0.75	0.31	0.75	1.31	1.19	0.0591
HK02C05	5/16	0.75	0.75	0.84	0.31	0.84	1.44	1.31	0.0682
HK02C06	3/8	0.88	0.88	1.00	0.38	1.00	1.63	1.63	0.0955
HK02C07	7/16	1.06	1.06	1.19	0.44	1.19	1.88	2.00	0.1682
HK02C08	1/2	1.06	1.06	1.19	0.44	1.19	1.88	2.00	0.1682
HK02C09	9/16	1.25	1.28	1.38	0.50	1.38	2.09	2.31	0.2682
HK02C10	5/8	1.25	1.28	1.38	0.50	1.38	2.09	2.31	0.2682
HK02C11	3/4	1.31	1.56	1.56	0.56	1.56	2.38	2.56	0.3818
HK02C12	7/8	1.63	1.81	1.81	0.63	1.81	2.88	3.06	0.5682
HK02C13	1	1.88	2.00	2.00	0.63	2.00	3.00	3.44	0.7545
HK02C14	1 1/8	2.00	2.06	2.75	0.75	2.75	3.38	4.00	1.1045

Din1142 Galv Malleable Wire Rope Clips

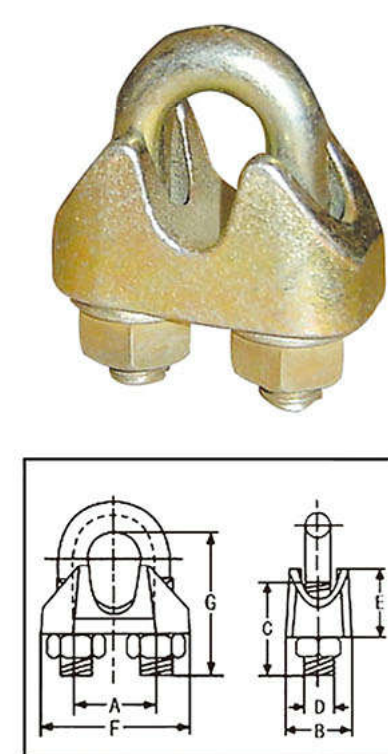

Product Code	Rope Size (mm)	Dimensions (mm)						Weight Each (Kg/pc)
		A	B	C	D	F	G	
HK04C01	5	12	13	13	5	25	25	0.021
HK04C02	6.5	14	16	14	6	30	32	0.040
HK04C03	8	18	20	20	8	39	41	0.082
HK04C04	10	20	20	24	8	40	46	0.092
HK04C05	13	27	28	30	12	55	64	0.275
HK04C06	16	32	32	35	14	64	76	0.430
HK04C07	19	36	32	36	14	68	83	0.490
HK04C08	22	40	34	40	16	74	96	0.680

Galv Malleable Wire Rope Clips Type A

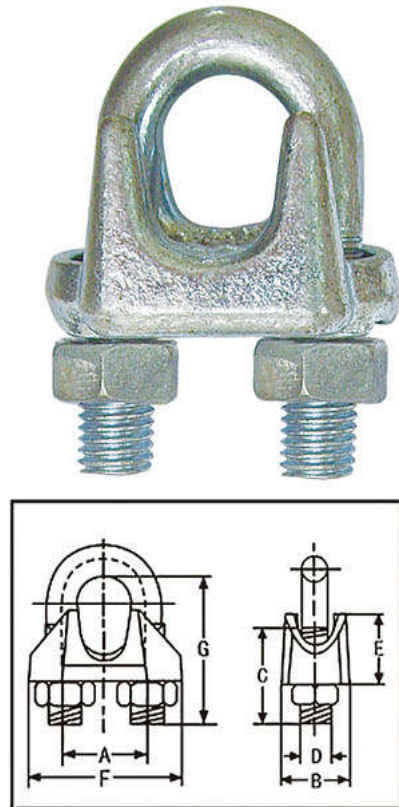

Product Code	Size (mm)	Dimensions (mm)							Weight /100Pcs (Kg/pc)
		A	B	C	D	E	F	G	
HK05C01	6	12	17	14	5	14	23	24	2.5
HK05C02	8	15	21	16	6	17	28	30	4.5
HK05C03	10	19	28	20	8	21	38	37	9.0
HK05C04	12	24	34	25	10	27	45	47	18.0
HK05C05	15	29	40	30	12	32	52	56	28.0
HK05C06	20	36	47	36	14	38	62	70	47.0
HK05C07	22	40	52	39	16	43	69	77	62.0
HK05C08	25	43	56	44	18	50	76	85	85.0
HK05C09	28	48	62	48	20	57	85	95	120.0
HK05C10	32	55	67	51	22	61	93	108	157.0
HK05C11	40	64	81	62	24	73	111	120	261.0
HK05C12	45	72	88	70	27	86	123	137	363.0
HK05C13	50	80	95	80	30	95	135	154	480.0

Galv Malleable Wire Rope Clips Type B

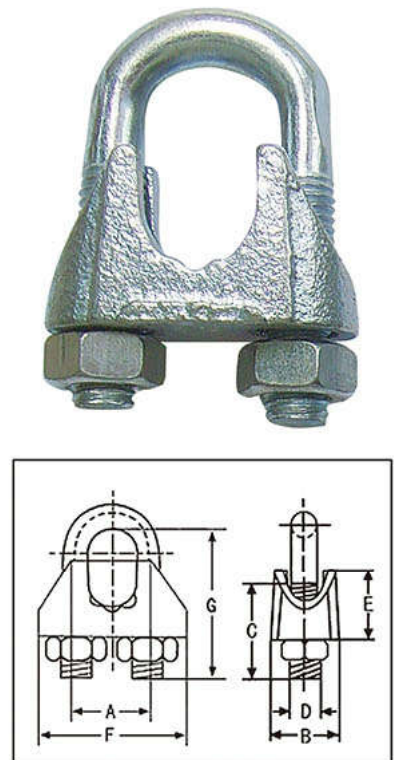

Product Code	Size (in)	Dimensions (mm)							Weight /100Pcs (Kg/pc)
		A	B	C	D	E	F	G	
HK06C01	1/8	9.0	12.0	12	4	9.5	19.0	20	1.17
HK06C02	3/16	11.0	13.5	14	5	10.8	22.0	26	1.70
HK06C03	1/4	12.5	15.5	14	5	11.5	25.0	26	2.53
HK06C04	5/16	15.5	18.0	16	6	16.0	31.0	31	3.80
HK06C05	3/8	21.0	22.0	20	8	20.0	40.0	37	7.93
HK06C06	1/2	25.0	25.0	24	10	26.0	47.0	46	14.40
HK06C07	5/8	30.0	28.0	28	12	31.0	55.0	57	23.08
HK06C08	11/16	33.0	28.5	30	12	35.0	58.5	64	26.80
HK06C09	3/4	36.5	31.0	34	16	36.0	65.0	71	44.30
HK06C10	7/8	40.0	36.0	38	16	43.0	72.0	77	57.00
HK06C11	1	45.0	40.0	44	20	48.0	80.0	88	88.43

U.S.Type Drop Forged Fist Grip Clips

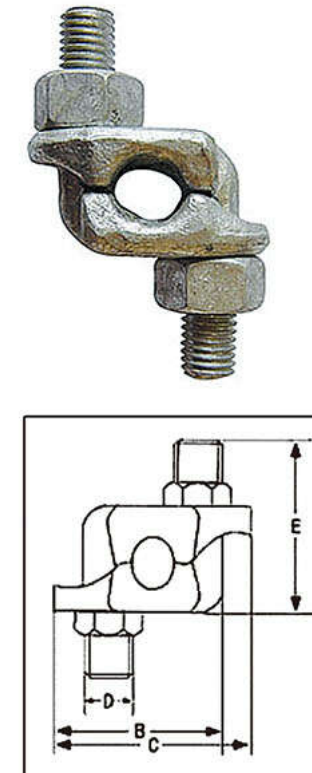

Meet The Requirements Of Federal Specification
FF-C-450 Type 3, Class 1.

Product Code	Rope Size (in)	Dimensions (mm)				
		A	B	C	D	E
HK07C01	3/16-1/4	6.35	31.75	37.3	9.65	32.50
HK07C02	5/16	7.78	34.04	39.69	9.65	37.34
HK07C03	3/8	9.65	40.39	47.63	11.18	45.97
HK07C04	7/16	12.70	47.75	55.56	12.70	55.60
HK07C05	1/2	12.70	47.75	55.56	12.70	55.60
HK07C06	9/16	16.00	57.90	66.68	16.00	68.33
HK07C07	5/8	16.00	57.90	66.68	16.00	68.33
HK07C08	3/4	19.05	68.33	77.79	19.05	74.68
HK07C09	7/8	22.35	75.44	79.38	19.05	84.07
HK07C10	1	25.40	78.23	89.69	19.05	94.50
HK07C11	1 1/8	28.70	87.38	99.22	22.35	106.17
HK07C12	1 1/4	31.75	90.42	102.30	22.35	107.95
HK07C13	1 3/8	38.10	104.90	118.27	25.40	141.22
HK07C14	1 1/2	38.10	104.90	118.27	25.40	141.22

Single Wire Rope Clips



HK08C

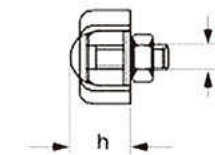
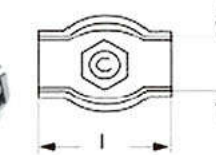

Duplex Wire Rope Clips



HK09C

Product Code	Size (mm)	Dimensions (mm)			
		b	d	h	l
HK08C01	2	4.0	4.0	5.0	15.0
HK08C02	3	5.0	4.0	7.0	17.0
HK08C03	4	8.0	6.0	7.0	20.0
HK08C04	5	10.0	6.0	8.0	25.0
HK08C05	6	13.0	6.0	10.0	30.0
HK08C06	8	18.0	8.0	12.0	38.0
HK08C07	10	21.5	10.0	15.0	42.0
HK09C01	2	4.0	4.0	6.0	30.0
HK09C02	3	7.0	4.0	7.0	35.0
HK09C03	4	8.0	5.0	7.5	40.0
HK09C04	5	10.0	5.0	10.0	50.0
HK09C05	6	12.0	6.0	12.0	60.0
HK09C06	9	18.0	8.0	15.0	72.0
HK09C07	10	21.0	10.0	16.0	84.5

U.S.Type Heavy Duty Thimble G414

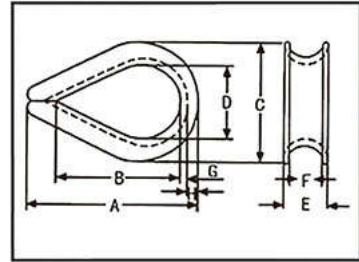

U.S.Type Light Duty Thimble G411

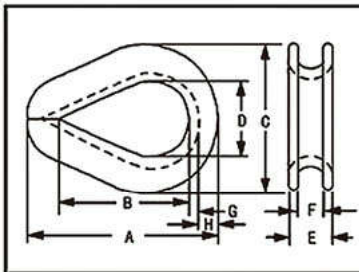

BS-464 Thimble Ordinary Thimbles For Steel Wire Rope

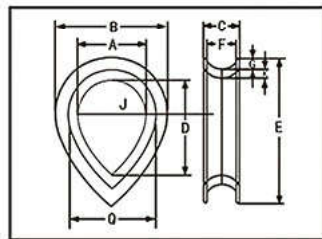

Meet The Requirements Of Federal Specification
FF-T-276B, Type 3

Product Code	Rope Dia. (in)	Dimensions (in)								Weight Each (Kg/pc)
		A	B	C	D	E	F	G	H	
HK01D01	1/4	2.19	1.63	1.50	0.88	0.41	0.28	0.06	0.23	0.030
HK01D02	5/16	2.50	1.88	1.81	1.06	0.50	0.34	0.08	0.28	0.054
HK01D03	3/8	2.88	2.13	2.13	1.13	0.63	0.41	0.11	0.34	0.098
HK01D04	7/16	3.25	2.38	2.38	1.25	0.72	0.47	0.13	0.38	0.158
HK01D05	1/2	3.63	2.75	2.75	1.50	0.81	0.53	0.14	0.41	0.232
HK01D06	9/16	3.63	2.75	2.69	1.50	0.88	0.59	0.14	0.41	0.232
HK01D07	5/8	4.25	3.25	3.13	1.75	0.97	0.66	0.16	0.50	0.344
HK01D08	3/4	5.00	3.75	3.81	2.00	1.22	0.78	0.22	0.66	0.719
HK01D09	7/8	5.50	4.25	4.25	2.25	1.38	0.94	0.22	0.75	0.808
HK01D10	1	6.13	4.50	4.94	2.50	1.56	1.06	0.25	0.88	1.427
HK01D11	1 1/8-1 1/4	7.00	5.13	5.88	2.88	1.81	1.31	0.25	1.13	1.818
HK01D12	1 1/4-1 3/8	9.00	6.25	6.81	3.50	2.19	1.44	0.38	1.13	3.686
HK01D13	1 3/8-1 1/2	9.06	6.50	7.13	3.50	2.56	1.56	0.50	1.13	5.885
HK01D14	1 5/8	11.25	8.00	8.13	4.00	2.72	1.72	0.50	1.38	7.727
HK01D15	1 3/4	12.19	9.00	8.50	4.50	2.84	1.84	0.50	1.31	8.068

Meet The Requirements Of Federal Specification
FF-T-276B, Type 2

Product Code	Rope Dia. (in)	Dimensions(in)								Weight Each (Kg/pc)
		A	B	C	D	E	F	G	H	
HK02D01	1/8	1.94	1.31	1.06	0.69	0.25	0.16	0.05	0.13	0.016
HK02D02	3/16	1.94	1.31	1.06	0.69	0.31	0.22	0.05	0.13	0.016
HK02D03	1/4	1.94	1.31	1.06	0.69	0.38	0.28	0.05	0.13	0.016
HK02D04	5/16	2.13	1.5	1.25	0.81	0.44	0.34	0.05	0.13	0.018
HK02D05	3/8	2.38	1.63	1.47	0.94	0.53	0.41	0.06	0.16	0.030
HK02D06	1/2	2.75	1.88	1.75	1.13	0.69	0.53	0.08	0.19	0.057
HK02D07	5/8	3.5	2.25	2.38	1.38	0.91	0.66	0.13	0.34	0.157
HK02D08	3/4	3.75	2.5	2.69	1.63	1.08	0.78	0.14	0.34	0.214
HK02D09	7/8	5	3.5	3.19	1.88	1.27	0.94	0.16	0.44	0.385
HK02D10	1	5.69	4.25	3.75	2.5	1.39	1.06	0.16	0.41	0.443
HK02D11	1 1/8-1 1/4	6.25	4.5	4.31	2.75	1.75	1.31	0.22	0.50	0.795

Product Code	Rope Dia. (in)	Dimensions (mm)									Weight Each (Kg/pc)
		A	B	C	D	E	F	G	K	Q	
HK03D01	5/16	22.2	38	12.7	33.4	52	7.9	4	4	30.1	0.077
HK03D02	3/8	25.4	47.6	14.3	38	64	10.3	6.3	4.8	35	0.100
HK03D03	7/16	28.6	52	17.5	41.3	73	12.7	7.9	4.8	38	0.107
HK03D04	1/2	31.7	53.8	20.6	44.5	79.4	14.3	7.9	5.5	42.9	0.170
HK03D05	9/16	31.7	58.8	20.6	44.5	79.4	14.3	7.9	5.5	42.9	0.189
HK03D06	5/8	41.3	74.5	22.2	58.8	95.8	15.9	8.7	7.9	56	0.300
HK03D07	3/4	50.8	92	28.6	73	124	20.6	11.1	9.5	69.8	0.600
HK03D08	7/8	56.0	102	31.7	82.5	133	22.2	12.7	9.5	76.2	0.690
HK03D09	1	69.8	119	35	108	162	27	14.3	10.3	90.5	1.150
HK03D10	1-1/8	76.2	133	38	112	178	28.6	15.9	12.7	102	1.400
HK03D11	1-1/4	95.0	152	41.3	133	197	33.4	15.9	12.7	121	1.500
HK03D12	1-3/8	105	175	47.6	152	228	38	19	15.9	137	2.500
HK03D13	1-1/2	114	197	52	165	254	41.3	23.8	17.5	149	3.750
HK03D14	1-5/8	114	197	58.6	165	254	42.9	23.8	17.5	149	3.910
HK03D15	1-3/4	127	228	56	178	286	50.8	25.4	25.4	178	6.670
HK03D16	1-7/8	133	248	66.6	190	317	60.4	28.6	28.6	190	8.420
HK03D17	2	140	257	69.8	203	330	64	30.1	28.6	197	9.980

Commercial Type Thimble

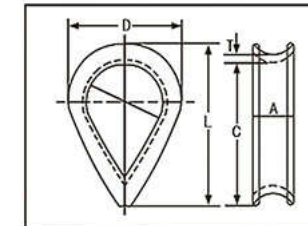

DIN 6899 Type "A" Wire Rope Thimbles

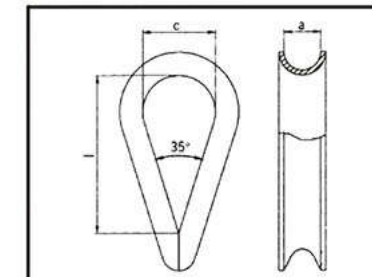

DIN 6899 Type "B" Wire Rope Thimbles

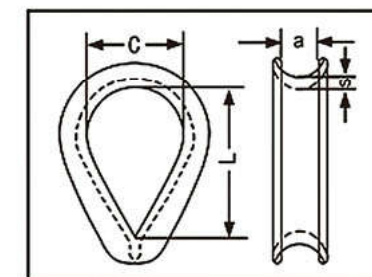

Product Code	Size (mm)	Dimensions (mm)						Weight /100Pc (kg)
		A	B	C	D	L	T	
HK04D01	6.0	11	19.00	30	29	38	2.5	1.7
HK04D02	8.0	13	21.00	35	30	45	2.5	3.7
HK04D03	10.0	16	25.00	38	37	51	3.0	4.4
HK04D04	12.0	18	32.00	49	45	64	3.0	7.3
HK04D05	16.0	22	45.00	75	59	90	3.2	15.5
HK04D06	20.0	25	49.00	81	67	102	4.8	20.0
HK04D07	22.0	32	55.00	89	78	114	4.8	28.0
HK04D08	24.0	33	59.00	99	83	127	5.5	40.0

Product Code	Rope Dia.	Switch Opening	Inside Length	Inside Width	Weight Each kg/pc
		a	i	C	
HK05D01	2.5	3	21.5	10	0.0014
HK05D02	3	3.5	23.5	11	0.0035
HK05D03	3.5	4	26.5	12	0.0038
HK05D04	4	5	28.5	13	0.0042
HK05D05	5	6	30	14	0.0080
HK05D06	6	7	33	15	0.0081
HK05D07	7	8	35	16	0.0110
HK05D08	8	9	39	18	0.0170
HK05D09	9	10	43	20	0.0210
HK05D10	10	11	47.5	22	0.0350
HK05D11	11	12	51.5	24	0.0370
HK05D12	12	13	56.5	26	0.0525
HK05D13	13	14	61	28	0.0725
HK05D14	15	16	69.5	32	0.0833
HK05D15	16	18	78	35	0.1790
HK05D16	18	20	86.5	40	0.2700
HK05D17	20	22	95	44	0.3550
HK05D18	24/26	26	105	48	0.5200

Product Code	Rope Dia.	Dimensions (mm)				Weight Each kg/pc
		A	L	C	S	
HK06D01	2.5	3	19	12	1.6	0.005
HK06D02	3.5	4	21	13	1.6	0.008
HK06D03	4	5	23	14	1.9	0.010
HK06D04	5	6	25	16	2.4	0.016
HK06D05	6	7	28	18	2.4	0.019
HK06D06	7	8	32	20	2.8	0.030
HK06D07	9	10	38	24	3.1	0.047
HK06D08	11	12	45	28	3.3	0.068
HK06D09	13	13	48	30	3.3	0.080
HK06D10	13	14	51	32	3.7	0.100
HK06D11	15	16	58	36	3.8	0.145
HK06D12	16	17	61	38	4.7	0.180
HK06D13	17	18	64	40	4.7	0.200
HK06D14	18	20	72	45	5.7	0.290
HK06D15	20	22	80	50	5.7	0.320
HK06D16	22	24	90	56	6.5	0.470
HK06D17	24	26	99	62	6.8	0.590
HK06D18	26	28	112	70	8	0.800
HK06D19	28	30	120	75	8	1.100
HK06D20	30	32	128	80	8	1.230
HK06D21	32	34	152	92	8.5	1.560
HK06D22	34	36	160	100	8.5	1.760
HK06D23	36	38	176	110	8.5	1.920

DIN580 Eye Screw

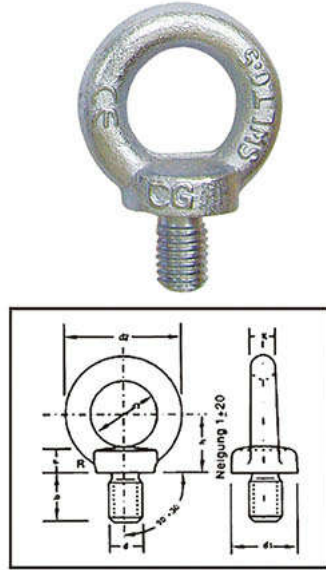

Product Code	Size (mm)	W.L.L (ton.)	W.L.L (ton.)	Dimensions (mm)							Weight Each (kg/pc)
				d1	d2	d3	b	e	h	k	
HK06E01	M6	0.07	0.05	17	28	16	13	6	17	6	0.050
HK06E02	M8	0.14	0.095	20	36	20	15	6	18	8	0.060
HK06E03	M10	0.23	0.17	25	45	25	18	8	22	10	0.110
HK06E04	M12	0.34	0.24	30	54	30	22	10	26	12	0.180
HK06E05	M14	0.49	0.34	35	63	35	28	12	30	14	0.285
HK06E06	M16	0.7	0.5	35	63	35	28	12	30	14	0.280
HK06E07	M20	1.2	0.83	40	72	40	30	12	35	16	0.450
HK06E08	M22	1.5	1.05	45	81	45	35	14	40	18	0.670
HK06E09	M24	1.8	1.27	50	90	50	38	16	45	20	0.780
HK06E10	M27	2.5	1.65	50	90	50	38	18	45	20	0.880
HK06E11	M30	3.6	2.6	65	108	60	45	18	55	24	1.660
HK06E12	M33	4.3	3.2	65	108	60	45	22	55	24	1.720
HK06E13	M36	5.1	3.7	75	126	70	55	22	65	28	2.650
HK06E14	M39	6.1	4.3	75	126	70	55	26	65	28	2.800
HK06E15	M42	7	5	85	144	80	65	30	75	32	4.030
HK06E16	M45	8	5.5	85	144	80	65	30	75	32	4.250
HK06E17	M48	8.6	6.1	100	166	90	70	35	85	38	6.380
HK06E18	M52	9.9	7.3	100	166	90	70	35	85	38	6.600
HK06E19	M65	11.5	8.3	110	184	100	80	38	95	42	8.800
HK06E20	M64	16	11	120	206	110	90	42	100	48	12.400

Chain Swivel G401

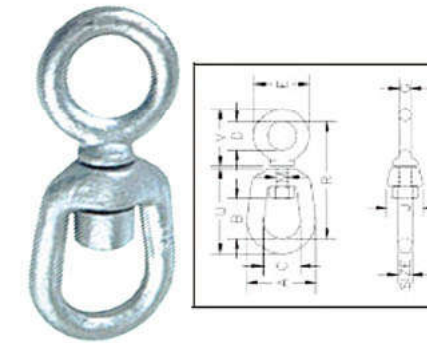

Product Code	Size (mm)	Dimensions (mm)											W.L.L (t)	Weight Per100
		A	B	C	D	E	G	J	M	R	U	V		
HK09E01	1/4"	31.8	17.5	19.1	15.7	28.4	6.35	17.5	7.85	57	42.9	31.8	0.43	20.2
HK09E02	5/16"	41.4	20.6	25.4	19.1	35.1	7.85	20.6	9.65	69	52.5	37.3	0.63	36.5
HK09E03	3/8"	51	23.9	31.8	25.4	44.5	9.65	25.4	12.7	87.5	63.5	47.8	1.10	70.0
HK09E04	1/2"	63.5	33.3	38.1	31.8	57	12.7	33.3	16	108	81	62	1.80	141.0
HK09E05	5/8"	76.2	39.6	44.5	38.1	70	15.8	38.1	19.1	130	98.5	74.5	2.60	249.5
HK09E06	3/4"	89	44.5	51	44.5	82.5	19.1	47.8	22.4	147	125	88	3.50	413.5

Ultimate Load is 5 times the Working Load Limit

DIN582 Ring Nut

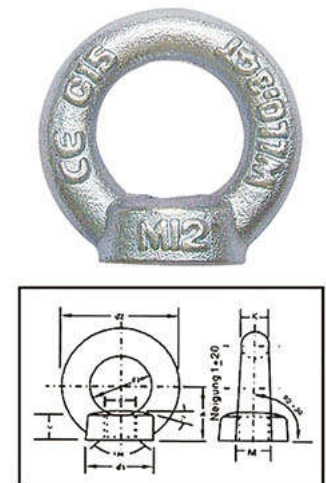

Product Code	Size (mm)	W.L.L (ton.)	Dimensions (mm)						Weight Each (kg/pc)
			d1	d2	d3	e	h	k	
HK07E01	M6	0.07	20	36	20	8.5	18	8	0.05
HK07E02	M8	0.14	20	36	20	8.5	18	8	0.05
HK07E03	M10	0.23	25	45	25	10	22	10	0.09
HK07E04	M12	0.34	30	54	30	11	26	12	0.16
HK07E05	M16	0.7	35	63	35	13	30	14	0.24
HK07E06	M20	1.2	40	72	40	16	35	16	0.36
HK07E07	M22	1.5	45	81	45	18	40	18	0.58
HK07E08	M24	1.8	50	90	50	20	45	20	0.72
HK07E09	M27	2.5	50	90	50	20	45	20	0.70
HK07E10	M30	3.6	65	108	60	25	55	24	1.32
HK07E11	M33	4.3	65	108	60	25	55	24	1.30
HK07E12	M36	5.1	75	126	70	30	65	28	2.08
HK07E13	M39	6.1	75	126	70	30	65	28	2.02

Swivel Jaw&Eye G403

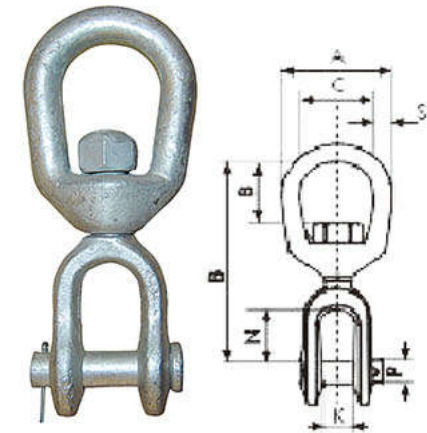

Product Code	Nominal Size (in)	Dimensions (in)						W.L.L (t)	Weight Per100
		A	B	C	N	K	R		
HK10E01	1/4"	1-1/4"	5/8"	3/4"	25/32"	15/32"	2-1/2"	0.43	18.5
HK10E02	5/16"	1-5/8"	3/4"	1"	27/32"	1/2"	2-7/8"	0.63	35.0
HK10E03	3/8"	2"	7/8"	1-1/4"	1-1/16"	5/8"	3-1/2"	1.10	67.5
HK10E04	1/2"	2-1/2"	1-1/4"	1-1/2"	1-15/32"	7/8"	4-9/16"	1.80	131.0
HK10E05	5/8"	3"	1-9/16"	1-3/4"	1-17/32"	1"	5-5/16"	2.60	240.0
HK10E06	3/4"	3-1/2"	1-3/4"	2"	1-3/4"	1-1/8"	6"	3.50	360.0

Ultimate Load is 5 times the Working Load Limit

Eye Nuts G-400

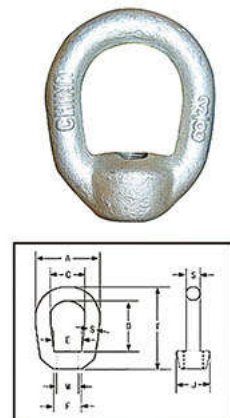

*Hot dip Galvanized;
*Forged Steel Quenched & Tempered
*Proof Load is 2 Times the Working Load Limit. Ultimate Load is 5 Times the Working Load

Product Code	Std. Tap Size (in)	W.L.L (Lbs)	Dimensions (in)							Weight Each (kg/pc)
			A	C	D	E	F	S	T	
HK05E01	1/4	520	1-1/4	3/4	1-1/16	1-1/32	1/2	1/4	1-11/16	0.0409
HK05E02	3/8	1250	1-5/8	1	1-1/4	3/4	9/16	5/16	2-1/16	0.0818
HK05E03	1/2	2250	2	1-1/4	1-1/2	1	1-3/16	3/8	2-1/2	0.1273
HK05E04	5/8	3600	2-1/2	1-1/2	2	1-3/16	1	1/2	3-3/16	0.2636
HK05E05	3/4	5200	3	1-3/4	2-3/8	1-3/8	1-1/8	5/8	3-7/8	0.4545
HK05E06	7/8	7200	3-1/2	2	2-5/8	1-5/8	1-5/16	3/4	4-5/16	0.7727
HK05E07	1	10000	4	2-1/4	3-1/16	1-7/8	1-9/16	7/8	5	1.2500
HK05E08	1 1/4	15500	4-1/2	2-1/2	3-1/2	1-15/16	1-7/8	1	5-3/4	1.7500
HK05E09	1 3/8	18500	5	2-3/4	3-3/4	2	2	1-1/8	6-1/4	2.2727
HK05E10	1 1/2	22500	5-5/8	3-1/8	4	2-3/8	2-1/4	1-1/4	6-3/4	3.0455
HK05E11	2	40000	7	4	6-1/4	4	3-3/8	1-1/2	10	8.5000

Swivel Eye&Eye G402

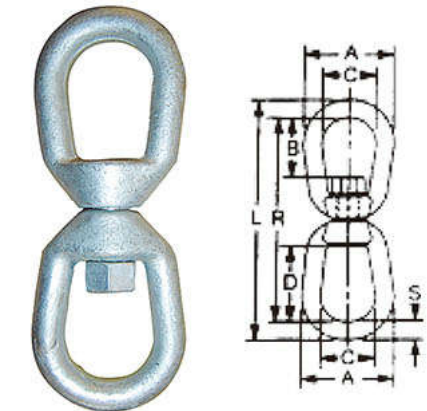

Product Code	Nominal Size (in)	Dimensions (in)						W.L.L (t)	Weight Per100
		A	B	C	D	E	R		
HK08E01	1/4"	1-1/4"	5/8"	3/4"	1"	1/2"	2-7/16"	0.26	14.0
HK08E02	5/16"	1-5/8"	3/4"	1"	1-1/4"	5/8"	2-15/16"	0.46	27.0
HK08E03	3/8"	2"	7/8"	1-1/4"	1-1/2"	3/4"	3-9/16"	0.62	47.5
HK08E04	1/2"	2-1/2"	1-1/4"	1-1/2"	2"	1"	4-9/16"	1.10	100.0
HK08E05	5/8"	3"	1-9/16"	1-3/4"	2-5/16"	1-1/4"	5-5/8"	1.60	169.0
HK08E06	3/4"	3-1/2"	1-3/4"	2"	2-3/4"	1-1/2"	6-1/8"	2.00	268.0

Ultimate Load is 5 times the Working Load Limit

Standard Load Binders 150

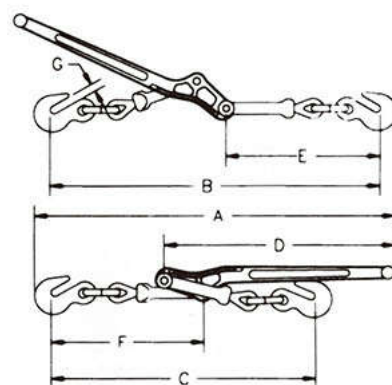

Product Code	Size (in)	W.L.L (lbs)	Proof Load (lbs)	Min Ultimate Load (lbs)	Kg/pc	Handle Length	Dimensions (in)						
							A	B	C	D	E	F	G
HK01F01	1/4-5/16	2200	4400	7800	1.600	11.42	18.50	17.30	14.17	11.42	8.27	8.07	0.35
HK01F02	5/16-3/8	5400	10800	19000	4.773	15.43	25.20	23.20	19.49	15.55	11.22	11.22	0.51
HK01F03	5/16-3/8	6600	13200	19800	4.891	17.24	28.50	26.38	22.05	17.64	12.99	12.20	0.59
HK01F04	3/8-1/2	9200	18400	33000	5.864	17.24	28.50	26.38	22.05	17.64	12.99	12.20	0.59
HK01F05	1/2-5/8	13000	26000	46000	6.536	21.00	33.86	30.12	25.87	20.87	14.37	14.37	0.74

Indirect Load Binder

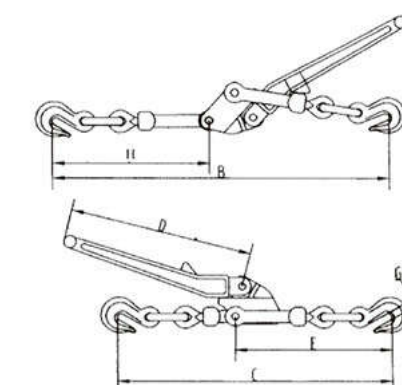

Product Code	Size (in)	W.L.L (lbs)	Proof Load (lbs)	Min Ultimate Load (lbs)	Kg/pc	Handle Length	Dimensions (in)						
							A	B	C	D	E	H	G
HK03F01	5/16-3/8	5400	10800	19000	4.2045	13	37	23.62	18.9	12.6	11.02	11.02	0.51

Ratchet Load Binders 140

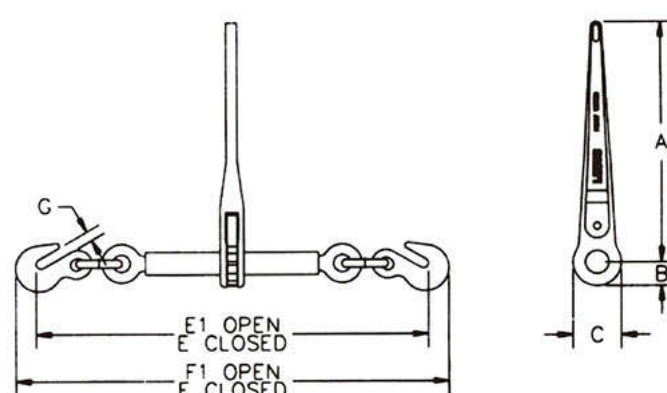

Product Code	Size (in)	W.L.L (lbs)	Proof Load (lbs)	Min Ultimate Load (lbs)	Kg/pc	Handle Length	Dimensions (in)						
							A	B	C	E	E1	F1	G
HK02F01	1/4-5/16	2200	4400	7800	1.600	7.16	7.16	0.89	1.77	16.22	21.62	17.79	0.35
HK02F02	5/16-3/8	5400	10800	19000	4.773	13.42	13.92	1.30	2.60	22.64	30.64	25.24	0.51
HK02F03	5/16-3/8	6600	10800	19800	4.891	13.42	13.92	1.30	2.60	22.64	30.64	25.24	0.51
HK02F04	3/8-1/2	9200	18400	33000	5.864	13.92	13.92	1.30	2.60	24.13	32.13	27.04	0.59
HK02F05	1/2-5/8	13000	26000	46000	6.536	13.92	13.92	1.30	2.60	26.45	34.45	30.07	0.74

Ultimate Load is 3 times the Working Load Limit

Binderless Links & Hooks

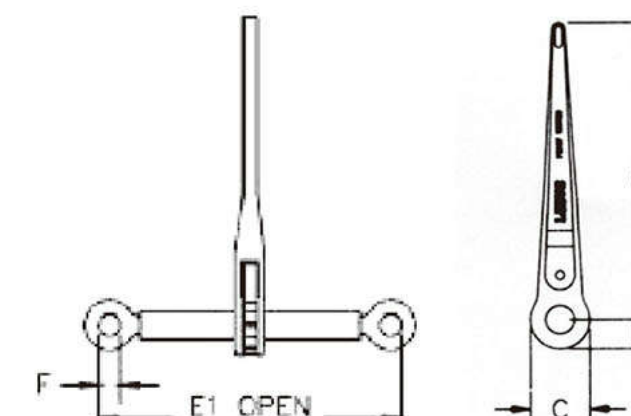

Product Code	Size (in)	W.L.L (lbs)	Proof Load (lbs)	Min Ultimate Load (lbs)	Kg/pc	Handle Length	Dimensions (in)				
							A	B	C	E1	F
HK04F01	5/16-3/8	5400	10800	19000	3.545	13.42	13.92	1.30	2.60	21.70	0.79
HK04F02	3/8-1/2	9200	18400	33000	3.545	13.92	13.92	1.30	2.60	21.70	1.02
HK04F03	1/2-5/8	13000	26000	46000	3.864	13.92	13.92	1.30	2.60	22.17	1.02

Ultimate Load is 3 times the Working Load Limit

Clevis Grab Hooks H330/A330

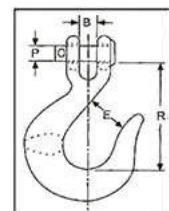

Note: Min Break Strength is 4 Times the WLL

Product Code	Size of chain	WLL (lbs)		Dimensions(in)				Weights (lbs)
		H-330	A-330	B	E	P	R	
HK01G01	1/4"	2600	3500	7/6	11/32	3/8	1-13/16	0.38
HK01G02	5/16"	3900	4700	1/2	7/16	3/8	2-5/32	0.70
HK01G03	3/8"	5400	7100	19/32	1/2	7/16	2-15/32	1.04
HK01G04	7/16"	7200	8500	21/32	9/16	9/16	2-25/32	1.31
HK01G05	1/2"	9200	12000	3/4	5/8	5/8	3-7/32	2.06
HK01G06	5/8"	13000	15800	29/32	3/4	3/4	4-3/32	4.25
HK01G07	3/4"	20200	24700	15/16	15/16	7/8	4-5/8	6.50

Eye Slip Hooks H324/A324

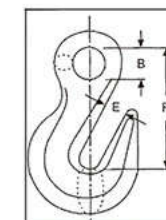

Product Code	Size of chain	Working Load Limit (lbs)		Dimensions(in)			Weights (lbs)
		H-324	A-324	B	E	R	
HK04G01	1/4"	1950	2750	1/2	15/16	2-17/32	0.40
HK04G02	5/16"	2875	4300	5/8	1-1/16	2-29/32	0.70
HK04G03	3/8"	4000	5250	23/32	1-5/16	3-5/16	1.00
HK04G04	7/16"	5000	7000	13/16	1-9/16	3-7/8	1.56
HK04G05	1/2"	6500	9000	15/16	1-11/16	4-9/32	2.31
HK04G06	5/8"	9250	13500	1-1/8	2	5-7/32	37.5
HK04G07	3/4"	-	19250	1-3/8	2-1/8	5-25/32	6.56

Clevis Slip Hooks H331/A331

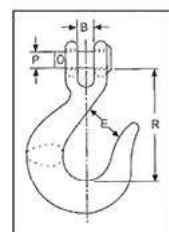

Note: Min Break Strength is 4 Times the WLL

Product Code	Size of chain	Working Load Limit (lbs)		Dimensions(in)				Weights (lbs)
		Slip Hook Application						
		H-331	A-331	B	E	P	R	
HK02G01	1/4"	1950	2750	7/16	15/16	3/8	2-9/16	0.50
HK02G02	5/16"	2875	4300	13/32	1.1/16	7/16	2-23/32	0.75
HK02G03	3/8"	4000	5250	19/32	1-5/16	15/32	3-1/4	1.20
HK02G04	7/16"	5000	7000	9/16	1-9/16	9/16	3-21/32	2.06
HK02G05	1/2"	6500	9000	3/4	1-11/16	5/8	4	2.75
HK02G06	5/8"	9250	13500	13/16	2	3/4	4-15/16	4.75
HK02G07	3/4"	-	19250	1-5/16	2-1/2	1	6-3/32	10.3

Eye Hoist Hooks 320C/320A

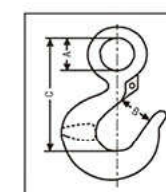

Note: Min Break Strength is 4.5/5 Times the WLL

Product Code	Working Load Limit(tons)		Dimensions(in)			Weights (lbs)	Weights (lbs) w/latch
	Carbon	Alloy	A	B	C		
HK05G01	1/2	3/4	0.63	0.87	2.80	0.35	0.37
HK05G02	3/4	1	0.75	0.94	3.22	0.55	0.57
HK05G03	1	1 1/2	0.91	1.03	3.66	0.75	0.77
HK05G04	1 1/2	2	1.12	1.06	4.09	1.25	1.28
HK05G05	2	3	1.25	1.22	4.69	1.70	0.73
HK05G06	3	5	1.56	1.5	5.78	3.60	3.66
HK05G07	5	7	2.00	1.88	7.38	7.08	7.19
HK05G08	7 1/2	11	2.44	2.25	9.06	13.0	13.17
HK05G09	10	15	2.83	2.52	10.09	22.0	22.15
HK05G10	15	22	3.54	3.46	12.20	33.8	-

Eye Grab Hooks H323/A323

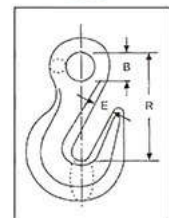

Note: Min Break Strength is 4 Times the WLL

Product Code	Size of chain	Working Load Limit (lbs)		Dimensions(in)			Weights (lbs)
		H-323	A-323	B	E	R	
HK03G01	1/4"	2600	3600	1/2	11/32	1-31/32	0.28
HK03G02	5/16"	3900	5400	16/9	7/16	2-1/4	0.45
HK03G03	3/8"	5400	7500	32/21	1/2	2-9/16	0.79
HK03G04	1/2"	9200	12750	8/7	21/32	3-3/8	1.75
HK03G05	5/8"	12750	19000	1-1/16	25/32	4-3/32	3.25
HK03G07	3/4"	18500	27000	1-3/8	15/16	5-5/32	5.94

Swivel Hoist Hooks 322C/322A

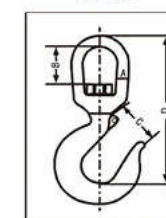

Note: Min Break Strength is 4.5/5 Times the WLL

Product Code	Working Load Limit(tons)		Dimensions(in)				Weights (lbs)	Weights (lbs) w/latch
	Carbon	Alloy	A	B	C	D		
HK06G01	3/4	1	3/8	15/16	15/16	415/32	0.75	0.77
HK06G02	1	1 1/2	1/2	15/16	11/32	59/32	1.25	1.27
HK06G03	1 1/2	2	5/8	15/8	11/16	61/64	2.25	2.28
HK06G04	2	3	5/8	19/16	17/32	63/8	2.57	2.6
HK06G05	3	4 1/2	3/4	13/4	11/2	713/32	4.75	4.81
HK06G06	5	7	1	25/16	17/8	919/32	10.29	10.4
HK06G07	7 1/2	11	1-1/8	23/8	21/4	111/8	161/4	163/7
HK06G08	10	15	1-1/4	2 13/16	21/2	11 15/16	23.25	23.4

High Test Chain NACM84/90(G43)



Product Code	Nominal Size		Working Load Limit (max)		Proof Load (min)		Min. Breaking Load		Weight Per 100'		Inside length (max)		Inside Width (min)	
	inches	mm	kg	lb	kn	lb	kn	lb	kg	lb	mm	Inches	mm	Inches
HK05H01	1/4	7.0	1,180	2,600	16.6	3,750	33.1	7,500	30.0	66.1	31.5	1.24	9.8	0.38
HK05H02	5/16	8.0	1,770	3,900	21.6	4,900	43.2	9,700	39.0	86.0	32.8	1.29	11.2	0.44
HK05H03	3/8	10.0	2,450	5,400	33.0	7,600	67.6	15,200	67.3	148	35.0	1.38	14.0	0.55
HK05H04	1/2	13.0	4,170	9,200	57.1	12,900	114.2	25,700	110	242	45.5	1.79	18.2	0.72

Transport Chain NACM84/90(G70)



Product Code	Nominal Size		Working Load Limit (max)		Proof Load (min)		Min. Breaking Load		Weight Per 100'		Inside length (max)		Inside Width (min)	
	inches	mm	kg	lb	kn	lb	kn	lb	kg	lb	mm	Inches	mm	Inches
HK06H01	1/4	7.0	1,430	3,150	27.0	6,100	53.9	12,100	30.0	66.1	31.5	1.24	9.8	0.38
HK06H02	5/16	8.7	2,130	4,700	41.6	9,400	83.5	18,800	47	104	32.8	1.29	11.2	0.44
HK06H03	3/8	10.0	2,990	6,600	55.0	12,400	110.0	24,700	64.5	142	35.0	1.38	14.0	0.55

Proof Coil Chain NACM96(G30)



Product Code	Nominal Size		Material Diameter		Working Load Limit		Proof Test (min.)		Breaking Force Min		Inside length		Inside Width	
	mm	in	mm	in	kg	lbg	kn	lbg	kn	lbs	mm	in	mm	in
HK07H01	4.0	1/8	4.0	0.156	180	400	3.8	800	7.2	1600	23.9	0.94	6.4	0.25
HK07H02	5.5	3/16	5.5	0.217	365	800	7.2	1500	14.4	3200	24.8	0.98	7.7	0.30
HK07H03	7.0	1/4	7.0	0.276	580	1300	11.6	2600	23.2	5200	31.5	1.24	9.8	0.38
HK07H04	8.0	5/16	8.4	0.331	860	1900	16.9	3800	33.8	7600	32.8	1.29	11.2	0.44
HK07H05	10.0	3/8	10.0	0.394	1200	2650	23.5	5300	47.2	10600	35.0	1.38	14.0	0.55
HK07H06	11.9	7/16	11.9	0.468	1680	3700	32.9	7400	65.8	14800	41.5	1.64	16.6	0.65
HK07H07	13.0	1/2	13.0	0.512	2030	4500	40.0	9000	80.0	18000	45.5	1.79	18.2	0.72
HK07H08	16.0	5/8	16.0	0.630	3130	6900	61.3	13800	122.8	27600	56.0	2.20	20.0	0.79
HK07H09	20.0	3/4	20.0	0.787	4800	10600	94.3	21200	188.6	42400	70.0	2.78	25.0	0.98
HK07H10	22.0	7/8	22.0	0.866	5810	12800	114.1	25600	228.2	51200	77.0	3.03	27.5	1.08
HK07H11	26.0	1	26.0	1.020	8140	17900	159.10	35800	318.2	71600	90.9	3.58	31.7	1.25

High Test Chain NACM96 (G43)



Product Code	Nominal Chain Size		Material Diameter		Working Load Limit (max.)		Proof Test (min.)		Minimum Breaking Force		Inside Length (max.)		Inside Width (min.)	
	mm	in	mm	in	kg	lbg	kn	lbg	mm	in	mm	in	kg	lbg
HK08H01	7.0	1/4	7.0	0.276	1180	2600	17.3	3900	34.6	7800	31.5	1.24	9.8	0.38
HK08H02	8.7	5/16	8.7	0.343	1770	3900	26.0	5850	52.0	11700	32.8	1.29	11.2	0.44
HK08H03	10.0	3/8	10.3	0.406	2450	5400	36.0	8100	72.0	16200	35.0	1.38	14.0	0.55
HK08H04	11.0	7/16	11.9	0.468	3270	7200	48.0	10800	96.0	21600	41.6	1.64	16.6	0.65
HK08H05	13.0	1/2	13.5	0.531	4170	9200	61.3	13800	122.6	27600	45.5	1.79	18.2	0.72
HK08H06	16.0	5/8	16.0	0.630	5910	13000	86.5	19500	173.0	39000	56.0	2.20	20.0	0.79
HK08H07	20.0	3/4	20.0	0.787	9180	20200	134.7	30300	269.4	60000	70.0	2.76	25.0	0.98
HK08H08	22.0	7/8	22.0	0.866	11140	24500	163.3	36750	326.4	73500	77.0	3.03	27.5	1.08

Transport Chain NACM96 (G70)



Product Code	Nominal Size		Material Diameter		Working Load Limit		Proof Test (min.)		Breaking Force Min		Inside length		Inside Width	
	mm	in	mm	in	kg	lbg	kn	lbs	kn	lbs	mm	in	kg	lbg
HK09H01	7.0	1/4	7.0	0.281	1430	3150	28.0	6300	56.0	12600	31.8	1.24	9.8	0.38
HK09H02	8.7	5/16	8.7	0.343	2130	4700	41.8	9400	83.6	18800	32.8	1.29	11.2	0.44
HK09H03	10.0	3/8	10.3	0.406	2990	6600	58.7	13200	117.4	26400	35.0	1.38	14.0	0.55

DIN5685A/C Short/Long Link Chain



Product Code	SIZE	INSIDE LENGTH	OUTSIDE WIDTH	WEIGHT PER 100M	WORKING LOAD	BREAKING LOAD	GRADE
HK15H01	2	22	10	1.2	500	1250	A
HK15H02	2.5	27	12	1.5	750	2000	A
HK15H03	3	32	14	2.0	1120	2800	A
HK15H04	3.5	37	16	2.5	1500	3850	A
HK15H05	4	42	18	3.0	2000	5000	A
HK15H06	4.5	47	20	3.5	2500	6300	A
HK15H07	5	52	22	4.0	3150	7750	A
HK15H08	5.5	57	24	4.5	3800	9500	A
HK15H09	6	62	26	5.0	4500	11500	A
HK15H10	6.5	67	28	5.5	5400	13800	A
HK15H11	7	72	30	6.0	6000	15000	A
HK15H12	8	82	32	7.0	8000	20000	A
HK15H13	9	92	34	8.0	9000	22500	A
HK15H14	10	102	36	9.0	10000	25000	A
HK15H15	11	112	38	10.0	12500	31000	A
HK15H16	12	122	40	11.0	15000	38000	A
HK15H17	13	132	42	12.0	18000	45000	A
HK15H18	14	142	44	13.0	21200	53000	A

EN818-2 G80 CHAIN

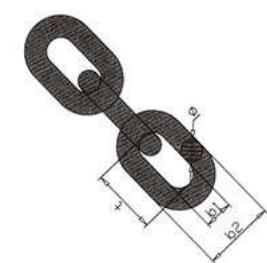

Product code	ITEM	WLL/T	B.L/T	(MM)	t/(MM)	(min)	(max)
HK16H01	6mm	1.12	4.48	6 ± 0.24	10 ± 0.5	7.8	22.2
HK16H02	7mm	1.5	6	7 ± 0.28	21 ± 0.6	9.1	25.9
HK16H03	8mm	2	8	8 ± 0.32	24 ± 0.7	10.4	29.6
HK16H04	10mm	3.15	12.6	10 ± 0.4	30 ± 0.9	13	37
HK16H05	13mm	5.3	21.2	13 ± 0.52	39 ± 1.2	16.9	48.1
HK16H06	16mm	8	32	16 ± 0.64	48 ± 1.4	20.8	59.2
HK16H07	18mm	10	40	18 ± 0.90	54 ± 1.6	23.4	66.6
HK16H08	20mm	12.5	50	20 ± 1.00	60 ± 1.8	26	74
HK16H09	22mm	15	60	22 ± 1.10	66 ± 2.0	28.6	81.4
HK16H10	26mm	21.2	84.8	26 ± 1.30	78 ± 2.3	33.8	96.2

Binder Chain



Product Code	SIZE	ASTM80			NACM90			NACM96			Pcs Per Drum
		W.T. Kg	WLL Lb	Mbs Lb	W.T. Kg	WLL Lb	Mbs Lb	W.T. Kg	WLL Lb	Mbs Lb	
Grade 43											
HK10H01	1/4x14	5.0	2,600	7,500	4.5	2,600	7,500	4.5	2,600	7,500	50
HK10H02	1/4x16	6.0	2,600	7,500	5.0	2,600	7,500	5.0	2,600	7,500	40
HK10H03	5/16x14	7.5	3,900	11,600	6.0	3,900	9,700	7.0	3,900	11,700	35
HK10H04	5/16x16	8.5	3,900	11,600	6.8	3,900	9,700	8.0	3,900	11,700	30
HK10H05	5/16x18	9.5	3,900	11,600	7.5	3,900	9,700	9.0	3,900	11,700	30
HK10H06	5/16x20	10.5	3,900	11,600	8.0	3,900	9,700	9.5	3,900	11,700	25
HK10H07	5/16x25	13.0	3,900	11,600	10.0	3,900	9,700	12.0	3,900	11,700	20
HK10H08	5/16x30	15.5	3,900	11,600	12.0	3,900	9,700	14.0	3,900	11,700	20
HK10H09	3/8x14	10.5	5,400	16,200	9.5	5,400	15,200	10.0	5,400	16,200	25
HK10H10	3/8x16	12.0	5,400	16,200	11.0	5,400	15,200	11.5	5,400	16,200	25
HK10H11	3/8x20	15.0	5,400	16,200	13.5	5,400	15,200	13.5	5,400	16,200	20
HK10H12	3/8x25	18.5	5,400	16,200	16.5	5,400	15,200	17.5	5,400	16,200	20

Binder Chain



Product Code	SIZE	ASTM80			NACM90			NACM96			Pcs Per Drum
		W.T. Kg	WLL Lb	Mbs Lb	W.T. Kg	WLL Lb	Mbs Lb	W.T. Kg	WLL Lb	Mbs Lb	
Grade70											
HK11H01	1/4x14	5.0	3,150	12,600	4.5	3,150	12,100	4.0	3,150	12,600	50
HK11H02	1/4x16	6.0	3,150	12,600	5.0	3,150	12,100	5.0	3,150	12,600	40
HK11H03	5/16x14	7.5	4,700	18,800	7.0	4,700	18,800	7.0	4,700	18,800	35
HK11H04	5/16x16	8.5	4,700	18,800	8.0	4,700	18,800	8.0	4,700	18,800	30
HK11H05	5/16x18	9.5	4,700	18,800	9.0	4,700	18,800	9.0	4,700	18,800	30
HK11H06	5/16x20	10.5	4,700	18,800	10.0	4,700	18,800	10.0	4,700	18,800	25
HK11H07	5/16x25	13.0	4,700	18,800	12.0	4,700	18,800	12.0	4,700	18,800	20
HK11H08	5/16x30	15.5	4,700	18,800	14.5	4,700	18,800	14.5	4,700	18,800	20
HK11H09	3/8x14	10.5	6,600	26,400	9.5	6,600	24,700	10.0	6,600	26,400	25
HK11H10	3/8x16	12.0	6,600	26,400	11.0	6,600	24	11.5	6,600	26,400	20
HK11H11	3/8x20	15.0	6,600	26,400	13.5	6,600	24	14.5	6,600	26,400	20
HK11H12	3/8x25	18.5	6,600	26,400	16.5	6,600	24	18.0	6,600	26,400	15

Snap hook, ZP



Product code	Size (mm)	W.L.L(lbs)	N.W.(kg/pc)
HK01N01	4×40	200	0.009
HK01N02	5×50	220	0.018
HK01N03	6×60	260	0.028
HK01N04	7×70	400	0.045
HK01N05	8×80	500	0.070
HK01N06	9×90	550	0.090
HK01N07	10×100	770	0.144
HK01N08	11×120	990	0.192
HK01N09	12×140	1200	0.270
HK01N10	13×160	1400	0.350
HK01N11	14×180	1600	0.500
HK01N12	15×200	1850	0.700

Snap Hook With Eyelet, ZP



Product code	Size (mm)	W.L.L(lbs)	N.W.(kg/pc)
HK02N01	4×40	200	0.009
HK02N02	5×50	220	0.020
HK02N03	6×60	260	0.030
HK02N04	7×70	400	0.050
HK02N05	8×80	500	0.075
HK02N06	9×90	550	0.098
HK02N07	10×100	770	0.160
HK02N08	11×120	990	0.210
HK02N09	12×140	1200	0.275
HK02N10	13×160	1400	0.358

Snap Hook With Screw, ZP



Product code	Size (mm)	W.L.L(lbs)	N.W.(kg/pc)
HK03N01	5×50	220	0.020
HK03N02	6×60	260	0.030
HK03N03	7×70	400	0.050
HK03N04	8×80	500	0.075
HK03N05	9×90	550	0.098
HK03N06	10×100	770	0.160
HK03N07	11×120	990	0.210
HK03N08	12×140	1200	0.270
HK03N09	13×160	1400	0.360

Snap hook with eyelet & screw, ZP



Product code	Size (mm)	W.L.L(lbs)	N.W.(kg/pc)
HK04N01	5×50	220	0.021
HK04N02	6×60	260	0.032
HK04N03	7×70	400	0.050
HK04N04	8×80	500	0.077
HK04N05	9×90	550	0.099
HK04N06	10×100	770	0.162
HK04N07	11×120	990	0.220
HK04N08	12×140	1200	0.280
HK04N09	13×160	1400	0.370

Snap hook, SS316



Product code	Size (mm)	W.L.L(lbs)	N.W.(kg/pc)
HK05N01	5×50	220	0.0170
HK05N02	6×60	260	0.0250
HK05N03	7×70	400	0.0425
HK05N04	8×80	500	0.0680
HK05N05	9×90	550	0.0930
HK05N06	10×100	770	0.1360
HK05N07	11×120	990	0.1900
HK05N08	12×140	1200	0.2500

Straight snap hook, ZP



Product code	Size (mm)	W.L.L(lbs)	N.W.(kg/pc)
HK06N01	5×50	220	0.0170
HK06N02	6×60	260	0.0255
HK06N03	8×80	500	0.0570
HK06N04	10×100	770	0.1360
HK06N05	11×120	990	0.1850

Quick link, ZP



Product code	Size (mm)	W.L.L(lbs)	N.W.(kg/pc)
HK07N01	3	300	0.007
HK07N02	3.5	400	0.008
HK07N03	4	500	0.012
HK07N04	5	660	0.020
HK07N05	6	880	0.035
HK07N06	7	1300	0.065
HK07N07	8	1760	0.078
HK07N08	9	2200	0.110
HK07N09	10	2640	0.135
HK07N10	11	2900	0.185
HK07N11	12	3300	0.135
HK07N12	14	6100	0.350
HK07N13	16	8100	0.500

Pear shaped quick link, ZP



Product code	Size (mm)	W.L.L(lbs)	N.W.(kg/pc)
HK08N01	2.5	100	0.0055

"S" high hook, ZP



Product code	Size (mm)	N.W.(kg/pc)
HK09N01	3	0.003
HK09N02	4	0.009
HK09N03	5	0.011
HK09N04	6	0.047
HK09N05	7	0.060
HK09N06	8	0.068
HK09N07	10	0.126
HK09N08	12	0.150

Delta Ring



Product code	Size (In)	Dimensions (mm)				MBS(lbs)	Weight (lbs)
		A	B	C	D		
HK10N01	3	107	60	14	20	18000	0.79
HK10N02	4	140	74	15	25	20000	1.37

Cold Shut



Product code	Chain size(in.)	W.L.L		Weight /100pcs (kg)
		In lbs	In kgs	
HK11N01	1/8	220	100	2
HK11N02	3/16	660	299	4-1/2
HK11N03	1/4	880	399	8
HK11N04	5/16	1760	798	17
HK11N05	3/8	2220	998	23
HK11N06	1/2	3300	1479	51

Repair & Lap Links



Product code	size (in.)	Weight/100pcs (kg)	W.L.L	
			IN LBS	IN KGS
HK12N01	1/8×3/4	1-1/8	190	86
HK12N02	3/16×1	3-1/4	240	109
HK12N03	7/32×1-1/4	4-3/4	250	113
HK12N04	1/4×1-1/4	6-3/4	400	181
HK12N05	9/32×1-1/2	8-1/4	525	238
HK12N06	1/4×1-1/2	7-1/4	400	181
HK12N07	1/4×2	9-3/4	400	181
HK12N08	5/16×1-1/2	13	950	431
HK12N09	5/16×2	17	1000	454
HK12N10	3/8×1-5/8	23	1250	567
HK12N11	3/8×2	26	1250	567
HK12N12	1/2×2-1/2	53	2125	964
HK12N13	5/8×2-1/2	81	1000	454

Double Clevis Link S-247



Product code	Size (in)	W.L.L.(lbs)	Weight (lbs)	Dimensions (in) Crosby Standard						
				A	B	C	D	E	F	G
HK13N01	1/4	2600	0.44	0.50	0.75	0.50	0.31	0.38	0.75	.50
HK13N02	5/16-3/8	5400	0.81	0.56	1.00	0.63	0.44	0.47	1.00	1.81
HK13N03	7/16	7000	1.28	0.69	1.13	0.69	0.56	0.59	1.09	2.19
HK13N04	1/2	9200	1.68	0.81	1.25	0.75	0.63	0.66	1.25	2.47
HK13N05	5/8	17500	2.91	0.78	1.63	1.00	0.75	0.83	1.51	3.03

Twin Clevis Link S-249



Product code	Size (in)	W.L.L.(lbs)	Weight (lbs)	Dimensions (in) Crosby Standard			
				A	B	C	D
HK14N01	1/4-5/16	4700	0.32	0.47	1.18	0.38	0.43
HK14N02	3/8	6600	0.44	0.53	1.34	0.47	0.48
HK14N03	7/16-1/2	11250	1.00	0.65	1.75	0.56	0.63
HK14N04	5/8	16500	1.32	0.78	2.12	0.69	0.75

Welded Round Ring



Product code	size (mm)	Weight/pc (kg)
HK16N01	3*20	0.0040
HK16N02	3*20	0.0058
HK16N03	4*20	0.0074
HK16N04	4*25	0.0090
HK16N05	4*30	0.0110
HK16N06	4*40	0.0140
HK16N07	4*50	0.0170
HK16N08	5*25	0.0150
HK16N09	5*30	0.0170
HK16N10	5*35	0.0190
HK16N11	5*40	0.0220
HK16N12	6*30	0.0250
HK16N13	6*35	0.0290
HK16N14	6*40	0.0320
HK16N15	6*45	0.0360
HK16N16	6*50	0.0390
HK16N17	6*60	0.0460
HK16N18	7*50	0.0540
HK16N19	7*65	0.0680
HK16N20	7*75	0.0780
HK16N21	8*40	0.0860
HK16N22	8*45	0.0960
HK16N23	8*50	0.0720
HK16N24	8*60	0.0850
HK16N25	8*75	0.1030
HK16N26	10*50	0.1170
HK16N27	10*60	0.1360
HK16N28	10*70	0.1550
HK16N29	12*70	0.2300
HK16N30	12*100	0.3200

FORGED ROUND RING

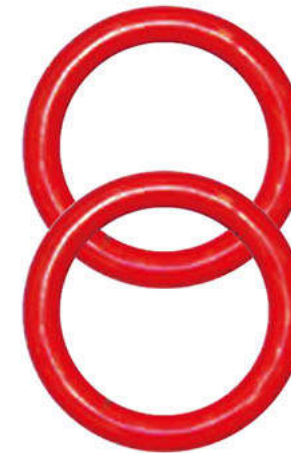

Product code	Size	WEIGHT/KG	WLL/T	B.L/T	A	D
HK24P01	3/4" X4"	0.85	1.8	7.2	102	19
HK24P02	7/8" X4"	1.2	3.5	14	102	22
HK24P03	7/8" X5" -1/2"	1.52	3.5	14	140	22
HK24P04	7/8" X6"	1.63	3.5	14	152	22
HK24P05	1" X4"	1.54	4.5	18	102	25
HK24P06	1" X5" -1/2"	2	4.5	18	140	25
HK24P07	1" X6"	2.14	4.5	18	152	25
HK24P08	1-1/8" X6"	2.73	6.5	26	152	28
HK24P09	1-1/4" X6"	3.65	9	36	152	32
HK24P10	1-1/4" X8"	4.66	9	36	203	32
HK24P11	1-1/4" X10"	5.67	9	36	254	32
HK24P12	1-3/8" X6"	4.45	9.5	38	152	35
HK24P13	1-3/8" X8"	5.65	9.5	38	203	35
HK24P14	1-1/2" X6"	5.3	10	40	152	38
HK24P15	1-1/2" X8"	6.74	10	40	203	38
HK24P16	1-1/2" X10"	8.2	10	40	254	38
HK24P17	1-3/4" X9"	10.6	16	64	229	45
HK24P18	2" X13" -1/2"	19.05	20	80	343	50

FORGED PEAR SHAPE LINK



Product code	Size	WEIGHT/KG	WLL/T	B.L/T	r	B	R	D
HK20P01	3/8"	0.1	0.8	3.2	10	28.5	19	10
HK20P02	1/2"	0.25	1.3	5.2	12.5	38	25.5	12.5
HK20P03	5/8"	0.5	1.9	7.6	16	47.5	32	16
HK20P04	3/4"	0.9	2.7	10.8	19	57	38	19
HK20P05	7/8"	1.3	3.8	15.2	22	67	44.5	22
HK20P06	1"	2	4.9	19.6	25	76	51	25
HK20P07	1-1/8"	2.54	6	24	28	86	57	28
HK20P08	1-1/4"	3.9	7.6	30.4	32	95	63.5	32
HK20P09	1-3/8"	5.2	9.3	37.2	35	105	70	35
HK20P10	1-1/2"	6.5	10	40	38	114	76	38
HK20P11	1-3/4"	10.5	15	60	45	135	90	45
HK20P12	2"	14.5	20	80	50	150	100	50
HK20P13	2-1/2"	28.8	25	100	63	189	126	63

G80 Web Sling Connector



Product code	Size	Kg/pc	WLL/T	B.L/T
HK01P01	6-8	0.200	1.2	4.8
HK01P02	7/8-8	0.300	2.0	8.0
HK01P03	10-8	0.676	3.2	12.8
HK01P04	13-8	1.470	5.4	21.6
HK01P05	16-8	2.300	8.2	32.0
HK01P06	20-8	3.300	12.5	50.0
HK01P07	22-8	7.000	15.0	60.0
HK01P08	26-8	11.600	21.2	84.8
HK01P09	32-8	20.000	32.0	128.0

G80 European Type Conneting Link



Product code	Size	Kg/pc	WLL/T	B.L/T
HK70P01	6-8	0.14	1.20	4.8
HK70P02	7/8-8	0.20	2.00	8.0
HK70P03	10-8	0.38	3.20	12.8
HK70P04	10-8	0.38	5.40	21.6
HK70P05	16-8	1.10	8.20	32.8
HK70P06	20-8	1.80	12.50	50.0
HK70P07	22-8	3.20	15.25	61.0
HK70P08	26-8	4.5	21.25	85.0
HK70P09	32-8	9	32.20	128.8

G80 Clevis Sling Hook With Latch A339



Product code	Size	KG/PC	WLL/T	B.L/T
HK11P01	6-8	0.32	1.12	4.48
HK11P02	8-8	0.52	2.0	8.0
HK11P03	10-8	1.05	3.15	12.6
HK11P04	13-8	2	5.3	21.2
HK11P05	16-8	3.7	8	32
HK11P06	20-8	6	12.5	50
HK11P07	22-8	10.4	15	60
HK11P08	26-8	14.5	21.2	84.8
HK11P12	32-8	27	31.5	126

G80 Eye Sling Hook With Latch



Product code	Size	KG/PC	WLL/T	B.L/T
HK12P01	6-8	0.30	1.12	4.48
HK12P02	8-8	0.4	2.0	8.0
HK12P03	10-8	0.9	3.15	12.6
HK12P04	13-8	1.7	5.3	21.2
HK12P05	16-8	3.2	8	32
HK12P06	20-8	5.8	12.5	50
HK12P07	22-8	8.5	15	60
HK12P08	26-8	13	21.2	84.8
HK12P12	32-8	17	31.5	126

G80 U.S Type Conneting Link A336



Product code	Size	Kg/pc	WLL/LB	B.L/LB
HK71P01	1/4"	0.25	3250	13000
HK71P02	3/8"	0.61	6600	26400
HK71P03	1/2"	1.25	11250	45000
HK71P04	5/8"	2.31	16500	66000
HK71P05	3/4"	4.13	23000	92000
HK71P06	7/8"	5.75	28750	115000
HK71P07	1"	8.12	38750	155000
HK71P08	1-1/4"	15.22	57500	230000

G80 U.S Type Conneting Link A337



Product Code	Size	Kg/pc	WLL/LB	B.L/LB
HK72P01	1/4"	0.29	4100	16400
HK72P02	3/8"	0.56	7300	29200
HK72P03	1/2"	1.06	13000	52000
HK72P04	5/8"	2.43	20300	81200
HK72P05	3/4"	4.20	29300	117200
HK72P06	7/8"	6.81	39900	159600
HK72P07	1"	8.22	52100	208400
HK72P08	1-1/4"	17.25	81400	325600

G80 LARGE OPENING EYE HOOK



Product code	Size	KG/PC	WLL/T	B.L/T
HK15P01	2T	0.7	2T	8T
HK15P02	3.2T	1	3.2T	12.8T
HK15P03	3.8T	1.3	3.8T	15.2T
HK15P04	5.4T	2.85	5.4T	21.6T
HK15P05	8.2T	4.9	8.2T	32.8T
HK15P06	12.5T	6.6	12.5T	50T

G80 Eye Foundry Hook A329



Product code	Size	Lbs/pc	WLL/Lb	B.L/Lb
HK14P01	1/4t	2.4	3500	14000
HK14P02	3/8"	4.5	7100	28400
HK14P03	1/2"	7.1	12000	48000
HK14P04	5/8"	12.2	18100	72400
HK14P05	3/4"	19.3	28300	113200
HK14P06	7/8"	26.3	34200	136800

G80 Clevis Self-Locking Safety Hook



Product code	Size	Kg /pc	WLL /T	B.L/T
HK43P01	6-8	0.45	1.2	4.8
HK43P02	7/8-8	0.85	2.0	8.0
HK43P03	10-8	1.45	3.2	12.8
HK43P04	13-8	2.90	5.4	21.6
HK43P05	16-8	5.60	8.2	32.8
HK43P06	18/20-8	6.50	12.5	50.0
HK43P07	22-8	16.0	15.0	60.0
HK43P08	26-8	18.5	21.2	84.8
HK43P09	32-8	-	31.5	126.0

G80 Swivel Self-Locking Safety Hook



Product code	Size	Kg /pc	WLL /T	B.L/T
HK44P01	6-8	0.7	1.2	4.8
HK44P02	7/8-8	1.3	2.0	8.0
HK44P03	10-8	2.2	3.2	12.8
HK44P04	13-8	3.64	5.4	21.6
HK44P05	16-8	8.2	8.2	32.8
HK44P06	18/20-8	11.7	12.5	50.0
HK44P07	22-8	16.0	15.0	60.0
HK44P08	26-8	21.5	21.2	84.8
HK44P09	32-8	-	31.5	126.0

G80 Eye Grab Hook A328



Product code	Size	Lbs /pc	WLL /LB	B.L/Lb
HK17P01	9/32(1/4)	0.60	3500	14000
HK17P02	3/8"	1.20	7100	28400
HK17P03	1/2"	3.00	12000	48000
HK17P04	3/4"	8.25	28300	113200
HK17P05	7/8"	11.90	34200	136800

G80 Clevis Grab Hook A338



Product code	Size	Lbs /pc	WLL /Lb	B.L/Lb
HK18P01	9/32(1/4)	0.62	3500	14000
HK18P02	3/8"	1.26	7100	28400
HK18P03	1/2"	3.45	12000	48000
HK18P04	5/8"	5.64	18100	72400
HK18P05	3/4"	10.69	28300	113200
HK18P06	7/8"	13.62	34200	136800

G80 Eye Self-Locking Safety Hook



Product code	Size	Kg /pc	WLL /T	B.L/T
HK42P01	6-8	0.5	1.2	4.8
HK42P02	7/8-8	0.8	2.0	8.0
HK42P03	10-8	1.5	3.2	12.8
HK42P04	13-8	3.2	5.4	21.6
HK42P05	16-8	6.1	8.2	32.8
HK42P06	18/20-8	7.5	12.5	50.0
HK42P07	22-8	13.4	15.0	60.0
HK42P08	26-8	14.5	21.2	84.8
HK42P09	32-8	-	31.5	126.0

G80 Clevis Shortening Grab Hook



Product code	Size	Kg/pc	WLL/T	B.L/T
HK46P01	6-8	0.245	1.2	4.8
HK46P02	7/8-8	0.320	2.0	8.0
HK46P03	10-8	0.730	3.2	12.8
HK46P04	13-8	1.600	5.4	21.6
HK46P05	16-8	2.800	8.2	32.8
HK46P06	20-8	4.130	12.8	51.2
HK46P07	22-8	6.300	16.0	64.0
HK46P08	26-8	-	21.2	84.8
HK46P09	32-8	-	31.5	126.0

High Tensile Hook



Product code	Size	Kg/pc	WLL/T	B.L/T
HK33P01	9	0.50	2.50	10.0
HK33P02	11	0.85	3.75	15.0
HK33P03	13	1.50	5.40	21.6

G80 Chain Shortener Link



Product code	Size	Kg/pc	WLL/T	B.L/T
HK35P01	6-8	0.21	1.2	4.8
HK35P02	7/8-8	0.40	2.0	8.0
HK35P03	10-8	0.94	3.2	12.8
HK35P04	13-8	1.75	5.4	21.6
HK35P05	16-8	3.16	8.2	32.8
HK35P06	20-8	6.20	12.5	50.0
HK35P07	22-8	8.50	15.0	60.0

G80 Clevis Forest Hook



Product code	Size	Kg/pc	WLL/T	B.L/T
HK49P01	7/8-8	0.46	2.0	8.0
HK49P02	10-8	0.89	3.2	12.8
HK49P03	13-8	1.75	5.4	21.6

G80 Eye Shortening Grab Hook



Product code	Size	Kg/pc	WLL /T	B.L/T
HK45P01	6-8	0.175	1.2	4.8
HK45P02	7/8-8	0.307	2.0	8.0
HK45P03	10-8	0.750	3.2	12.8
HK45P04	13-8	1.400	5.4	21.6
HK45P05	16-8	2.300	8.2	32.8
HK45P06	20-8	4.600	12.8	51.2
HK45P07	22-8	8.200	16.0	64.0
HK45P08	26-8	9.800	21.2	84.8
HK45P09	32-8	19.4000	31.5	126.0

G80 Enlarged Oblong Master Link Assembly A346

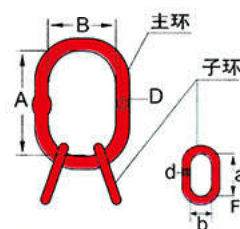

Product Code	Size	weight/kg	WLL/T	B.L/T	A	B	D	a	b	d
HK51P01	6-8	1.27	2.36	11.8	135	75	18	54	25	14
HK51P02	7-8	1.3	3.15	15.75	135	75	18	60	38	14
HK51P03	8-8	2.19	4.25	21.25	160	90	22	70	34	16
HK51P04	10-8	3.81	6.7	33.5	180	100	28	85	40	18
HK51P05	13-8	6.08	11.2	56	200	110	32	115	50	22
HK51P06	16-8	11.38	17	85	260	140	38	140	65	28
HK51P07	18-8	20.09	21.2	106	340	180	45	180	100	32
HK51P08	20-8	23.83	26.5	132.5	350	190	50	180	100	32
HK51P09	22-8	27.14	31.8	159	350	190	50	180	100	38
HK51P10	26-8	35.14	45	225	400	200	56	180	100	40
HK51P11	28-8	47.48	50	250	430	220	63	180	100	45

G80 Master Link A343 (NO FLAT DIN 5688)

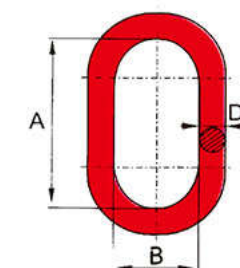

Product Code	Size	weight/kg	WLL/T	B.L/T	A	B	D
HK52P01	6-8	0.41	1.6	6.4	110	60	13
HK52P02	7-8	0.54	2.12	8.48	110	60	16
HK52P03	8-8	0.83	3.15	12.6	135	75	18
HK52P04	10-8	1.47	5.3	21.2	160	90	22
HK52P05	13-8	2.72	8	32	180	100	28
HK52P06	16-8	3.96	11.2	44.8	200	110	32
HK52P07	18-8	7.11	14	56	260	140	36
HK52P08	20-8	8.97	17	68	300	160	40
HK52P09	22-8	12.83	21.2	84.8	340	180	45
HK52P10	26-8	16.57	31.5	126	350	190	50
HK52P11	32-8	23.3	45	180	400	200	56
HK52P12	36-8	32.1	56	224	430	220	63
HK52P13	38-8	45.76	63	252	460	250	72

G80 Master Link A342

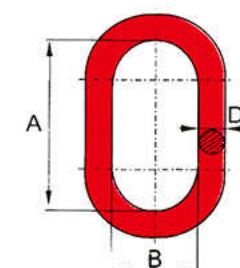

Product Code	Size	weight/kg	WLL/T	B.L/T	A	B	D
HK53P01	1/2"	0.45	2	8	127	63.5	13
HK53P02	5/8"	0.7	3	12	152	76	16
HK53P03	3/4"	1.04	4.7	18.8	140	70	19
HK53P04	7/8"	1.47	6.4	25.6	160	90	22
HK53P05	7/8"	1.57	8	32	178	89	22
HK53P06	1"	2.1	11	44	178	89	25
HK53P07	1-1/4"	4.2	16	64	222	111	32
HK53P08	1-1/2"	7.17	21.7	86.8	267	133	38
HK53P09	1-3/4"	11.55	28.4	113.6	305	152	45
HK53P10	2"	16.56	35	140	355	178	50
HK53P11	2"	16.56	45	180	355	178	50
HK53P12	2-1/2"	32.1	50	200	430	220	63
HK53P13	2-3/4"	42.5	60	240	450	250	70
HK53P14	3"	50.12	70	280	450	270	75
HK53P15	3-1/4"	59.11	80	320	480	250	80
HK53P16	3-1/2"	79.41	90	360	500	270	90
HK53P17	4"	115	100	400	600	300	100

G80 Master Link Assembly A345

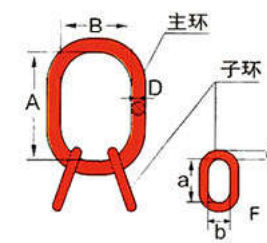

Product Code	Size	weight/kg	WLL/T	B.L/T	A	B	D	a	b	d
HK54P01	3/4"	1.55	4.7	18.8	140	70	20	60	35	14
HK54P02	7/8"	2.07	6.4	25.6	160	90	22	80	40	14
HK54P03	7/8"	2.7	8	32	178	89	22	85	40	18
HK54P04	1"	4.1	11	44	178	89	25	100	50	22
HK54P05	1-1/4"	6.9	16	64	222	111	32	100	50	25
HK54P06	1-1/2"	12.63	21.7	86.8	267	133	38	180	100	28
HK54P07	1-3/4"	17.1	28.4	93.6	305	152	45	147	75	32
HK54P08	2"	27.2	35	140	350	190	50	180	100	38
HK54P09	2-1/4"	35.14	45	180	400	200	56	180	100	40
HK54P10	2-1/2"	46.7	50	200	430	220	63	200	120	42
HK54P11	2-3/4"	75.62	60	240	450	250	70	350	190	50
HK54P12	3"	83.32	70	280	450	270	75	350	190	50
HK54P13	3-1/4"	88.5	80	320	480	250	80	350	190	50

G80 Master Link (Welded) A344

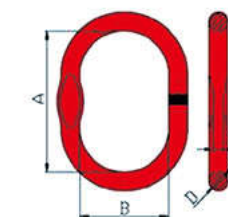

Product Code	Size	Weight/Kg	CHAIN(4:1)		STEEL(5:1)		A	B	D	S
			WLL/T	B.L/T	WLL/T	B.L/T				
HK55P01	7/16"	0.27	1.6	6.4	1.2	6	100	60	12	6
HK55P02	1/2"	0.38	2.76	11.04	2.2	11	100	60	14	7.6
HK55P03	11/16"	0.85	4	26	3.2	16	160	90	18	8.4
HK55P04	3/4"	1.2	6.5	26	5.2	26	160	90	20	10.4
HK55P05	7/8"	1.63	8.2	32.8	6.5	32.5	180	100	22	13.5
HK55P06	1"	2.13	11.5	46	9.2	46	180	100	25	16.5
HK55P07	1-1/8"	3.81	11.8	47.2	9.4	47	270	140	28	—
HK55P08	1-1/4"	5.05	16	64	12.8	64	270	140	32	—

G80 Welded Master Link Assembly A347

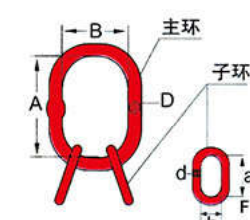

Product Code	Size	weight/kg	WLL/T	B.L/T	A	B	D	a	b	d
HK56P01	1/2"	0.82	2	10	100	60	14	85	40	12
HK56P02	11/16"	1.60	2.5	12.5	160	90	18	100	60	14
HK56P03	5/8"	1.61	2.5	12.5	160	90	18	100	60	14
HK56P04	3/4"	1.95	4	20	160	90	20	100	60	14
HK56P05	7/8"	3.16	6.4	32	180	100	22	150	70	18
HK56P06	1-1/8"	6.75	9.6	48	270	140	28	160	90	22
HK56P07	1-1/4"	9.31	13.9	69.5	270	140	32	180	100	25
HK56P08	1-1/2"	18.4	17	85	300	160	40	270	140	32
HK56P09	1-3/4"	26.4	21.2	106	340	180	45	285	155	36
HK56P10	2"	42.91	31.5	157.5	350	190	50	340	180	45

